



CT096 – HEAVY DUTY MORTISING MACHINE



COPYRIGHT © 2005 BY **CRAFTEX INDUSTRIES INC.**

NO PORTION OF THIS MANUAL MAY BE REPRODUCED WITHOUT
THE WRITTEN CONSENT OF CRAFTEX INDUSTRIES INC.



INDEX

GENERAL SAFETY INSTRUCTIONS	Page 3
Specifications	Page 4
Illustrated Features	Page 5
Receiving the Mortiser Installation	Page 6 Page 6
Adjustments	Page 7
Operation	Page 8-10
Maintenance	Page 10
Sharpening Chisel & Bit	Page 11-12
Parts List	
General	Page 13-14
Stand Assembly	Page 16
Clamping Bar Assembly	Page 17
Work Stop Assembly	Page 18
Schematic Diagrams	
General	Page 15
Stand Assembly	Page 16
Clamping Bar Assembly	Page 17
Work Stop Assembly	Page 18
Warranty	Page 19

GENERAL SAFETY INSTRUCTIONS

EXTREME CAUTION SHOULD BE USED IN OPERATING ALL POWER TOOLS. KNOW YOUR POWER TOOL, BE FAMILIAR WITH ITS OPERATION. READ THE OWNER'S MANUAL AND PRACTICE SAFE USAGE PROCEDURES AT ALL TIMES.

- ❑ **CONNECT** your machine **ONLY** to the matched and specified power source.
- ❑ **WEAR SAFETY GLASSES, HEARING PROTECTION and SAFETY SHOES** when operating heavy machinery. **Always wear safety glasses.**
- ❑ **DO NOT** wear loose clothing or jewellery when operating machinery.
- ❑ **A Safe Environment is important.** Keep the area free of dust, dirt and other debris in the immediate vicinity of the machine.
- ❑ **BE ALERT!** Do Not Use prescription or other drugs that may affect your ability or judgement to safely use this machine.
- ❑ **DISCONNECT** the power source when making other adjustments or repairs.
- ❑ **NEVER** leave an operating tool unattended.
- ❑ **NEVER** reach over the table when the tool is in operation.
- ❑ **ALWAYS** keep blades, knives or bits sharp and properly aligned.
- ❑ **ALWAYS** keep all safety guards in place and ensure their proper function.
- ❑ **ALWAYS** make sure that any tools used for adjustments are removed before operating the machine.
- ❑ **ALWAYS** secure your work with the appropriate clamps or vises.
- ❑ **ALWAYS** keep bystanders safely away while operating machinery.
- ❑ **THINK SAFETY. WORK SAFELY.** Never attempt a procedure if it does not feel safe or comfortable.

CT096 – H.D MORTISING MACHINE **SPECIFICATIONS**

As part of the growing line of Craftex woodworking equipment, we are proud to offer the CT096 Heavy Duty Mortising Machine. The Craftex name guarantees Craft Excellence. By following the instructions and procedures laid out in this owner's manual, you will receive years of excellent service and satisfaction. The CT096 is a professional tool and like all power tools, proper care and safety procedures should be adhered to.

Specifications

Motor: 1HP, 110V, 1 Phase, 60 Hz, 750w input (see nameplate)

Spindle Speed: 1700 RPM (see nameplate)

Chisel Capacity: ¼" – 1" (6.53 – 25.4mm)

Chisel Shank: ¾" (19.05mm)

Max. Chisel Stroke: 8.66" (220mm)

Distance, fence to center chisel: 5.5" (140mm)

Chuck Capacity: 5/8" (16mm)

Bushing Size: ¾" (19.05mm)

Table Movement

Long: 6.7" (170mm)

Cross: 5.5" (140mm)

Table Size: 16" x 6" (400 x 150mm)

CT096 – H.D MORTISING MACHINE **ILLUSTRATED FEATURES**

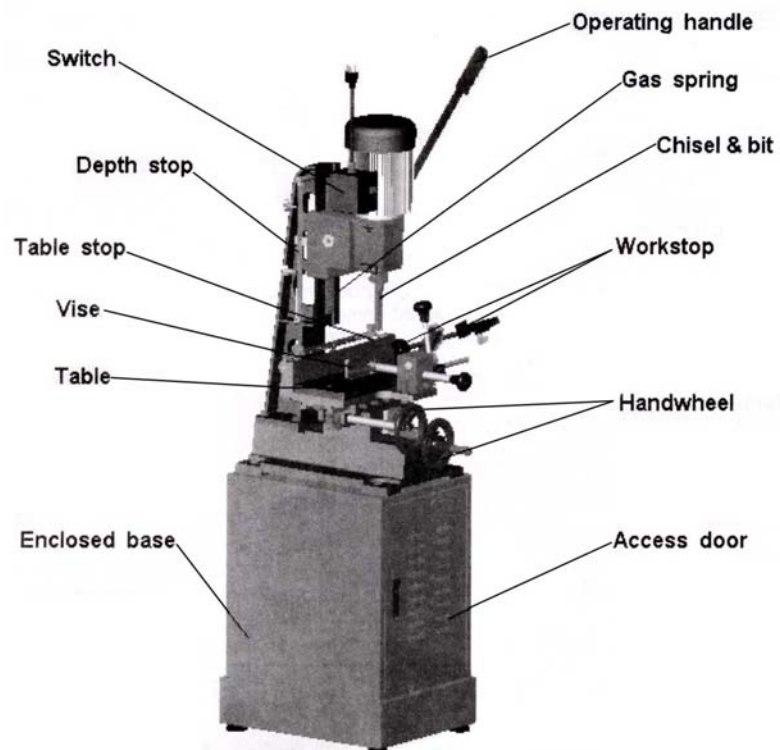

CT096 – H.D MORTISING MACHINE **RECEIVING THE MORTISER**

Remove the mortiser and stand from the shipping carton. Check for any damage that may have been caused during shipment and ensure that all parts are intact. Before you begin assembly, read the manual thoroughly, familiarizing yourself with the correct assembly, features, safety and maintenance procedures.

Contents of shipping cartons:

- 1 Stand
- 1 Hardware package

Mortiser Carton

- 1 Mortiser with motor
- 1 Operating handle
- 2 Handwheel handles
 - 1 Chuck key
 - 1 Chisel
- 1 Wooden table

INSTALLATION

The mortiser should be secured to the stand with the four M12 x 120 hex head screws (provided) using the holes in the base. Make sure there is enough room on each side of the mortiser for the size stock you plan to use

In the event of a malfunction or breakdown, grounding provides the path of least resistance for an electrical current to reduce the rise of electric shock. If you are not sure whether your outlet is properly grounded, please consult a qualified electrician.

CT096 – H.D MORTISING MACHINE

ADJUSTMENTS

Installing the Chisel & Bit

1. Loosen lock screw, as shown in Figure 2

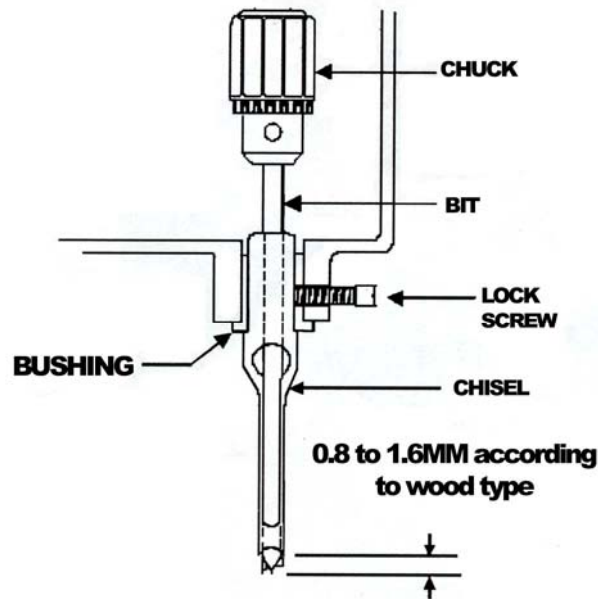

FIGURE 2

2. Insert chisel bushing (with the hole facing forward) into the head. Tighten the screw just enough to hold the chisel in place.

Note: Set the slot in the side of the chisel to the left or right, NOT the front or back. This will allow chips to escape when cutting mortises.

3. Push the chisel up as far as possible into the head. Then lower the chisel approximately 0.8mm to 1.6mm (0.3mm – 0.6mm), depending on the type of wood being worked on. Tighten the screw to hold the chisel in place.
4. Push the bit up through the chisel opening as far as it will go. Lock the drill bit in place with the chuck key.
5. Loosen the screw and push the chisel up against the bushing, then tighten the screw. This should provide the proper distance between the points of the chisel and the bit.

Work Stop

The work stop can be mounted to the table, as seen in Figure 3, It is tightened into place.

CT096 – H.D MORTISING MACHINE

OPERATION

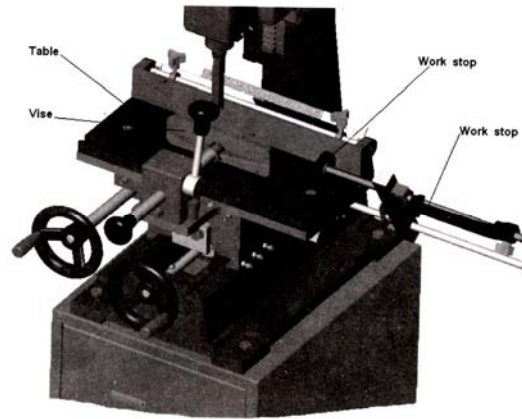

FIGURE 3

1. Set depth stop to the required depth of cut. See Figure 4

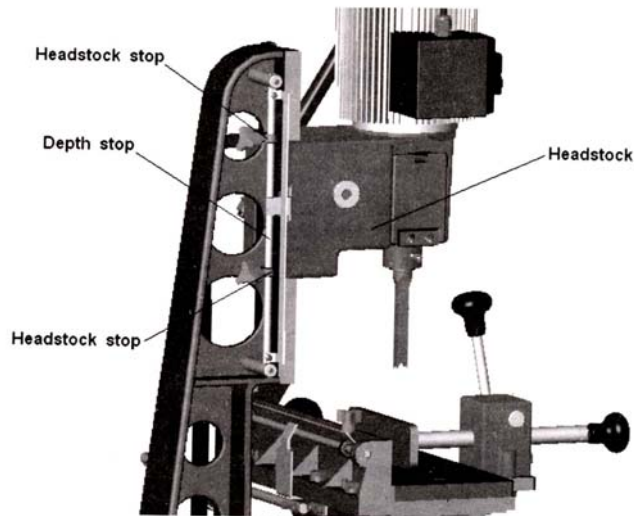

FIGURE 4

2. Place the workpiece on the table and clamp it with the vise. Use the right handwheel to move the table forward or backward to suit the position of the mortise on the workpiece.
3. Adjust the table stops, see Figure 5. According to the length of the cut required, then tighten the thumb screw

CT096 – H.D MORTISING MACHINE

OPERATION Cont...

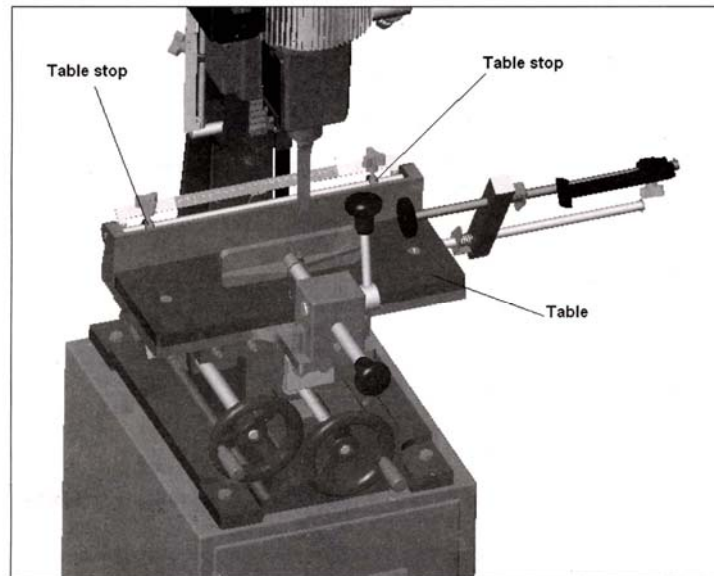

FIGURE 5

4. Turn the machine on and feed the chisel and bit steadily into the work piece by pulling down the operating handle.

NOTE: The rate of feed must be fast enough to prevent burning at the tip of the bit, but not so fast as to cause the machine to slow or stall. The different rates of feed for different woods must be learned through experience.

5. After the first cut, the workpiece is moved along with the left handwheel for each successive cut. The direction of movement must allow the chips to clear freely. Move the workpiece so that the slot in the chisel is releasing chips into the already cut part of the workpiece. See Figure 6.

CT096 – H.D MORTISING MACHINE

OPERATION Cont...

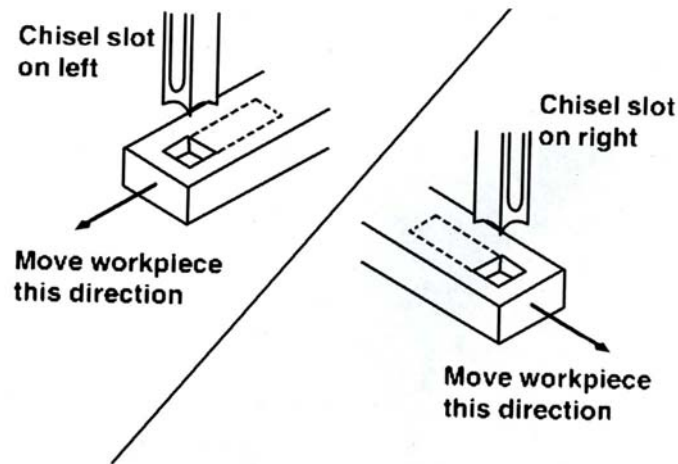

FIGURE 6

CAUTION: Do not have the chisel slot against the blind end of the mortise, as the chips will not be able to clear the chisel. This can cause overheating and possible breakage of the chisel or bit.

When cutting deep mortises, make the cut in several stages of approximately 1" each to allow chips to clear. To prevent breakout at the back of the workpiece when cutting through mortises, use a scrap piece of material under the workpiece as support.

MAINTENANCE

The mortiser only requires minor maintenance, such as cleaning and lubrication and routing adjustments and sharpening of the chisel bit.

Dust the machine down after each use and, as necessary, use light applications of oil or grease to lubricate linkages, moving parts etc.

CT096 – H.D MORTISING MACHINE

Sharpening Chisel & Bit

The chisel and bit should be kept sharp for the best performance. Blunt edges will give inaccurate mortises and can lead to overheating and breakage of chisel or bit. If the chisels and bit are badly worn and become difficult to sharpen, they should be replaced.

1. Sharpen the bit by using a small, smooth file, following the original shape of the bit. File the inside edge of the spur, the sides of the brad point and the cutting edge inwards toward the flute of the bit. See Figure 7

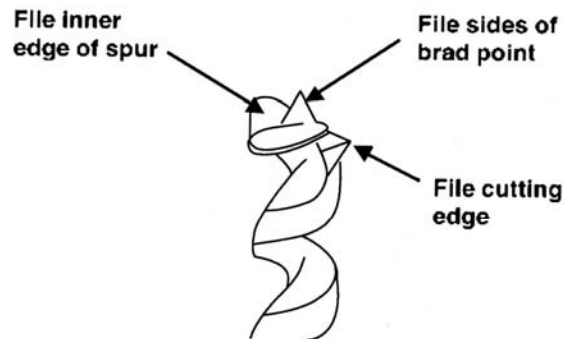

FIGURE 7

DO NOT file the outside edge of the spur, as this will affect the diameter of the bit.

CT096 – H.D MORTISING MACHINE

Sharpening Chisel & Bit

2. Sharpen the chisel with a mortise chisel cutter with the correct size pilot. (Pilot size will differ depending on the size of your chisel) Two or three turns of the cutter in a carpenters brace chuck should be enough to sharpen the chisel, as shown in Figure 8.

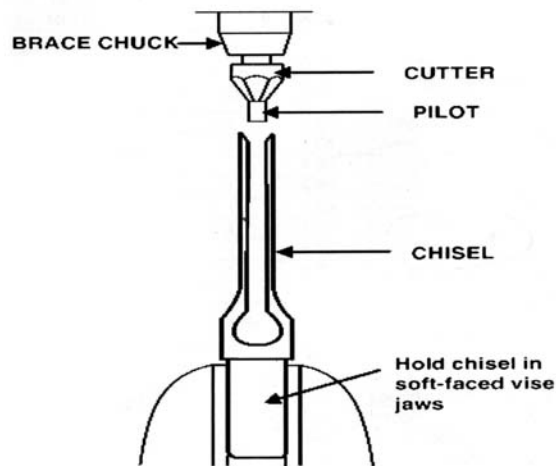

FIGURE 8

3. Use a small, triangular, smooth file to relieve the inner corners of the chisel. See figure 9.
Remove any burrs from the outside of the chisel with a fine oilstone.

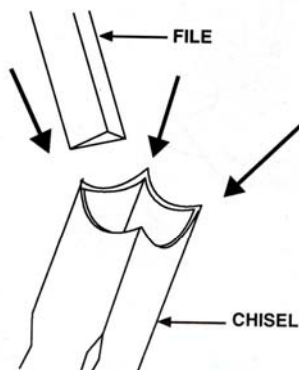

FIGURE 9

CT096 – H.D MORTISING MACHINE

PARTS LIST

NO.	Description	Quantity	NO.	Description	Quantity
A-1	Base	1	A-51	Handle	1
A-2	Middle Base	1	A-52	Motor	1
A-3	Drift	1	A-53	Handle Grip	1
A-4	Set Screw, M6x35	4	A-54	Power Cord	1
A-5	Hex Nut, M6	4	A-55	Strain Relief Bushing	1
A-6	Washer, 10	4	A-56	Switch Box	1
A-7	Wave Washer, 10	4	A-57	Switch	1
A-8	Cap Screw, M10x40	4	A-58	Screw, M4x15	2
A-9	Column	1	A-59	Screw, M6x25	4
A-10	Screw	1	A-60	Chuck, 16mm	1
A-11	Gas Spring	1	A-61	Screw, M6x10	1
A-12	Set Screw, M6x35	3	A-62	Cover	1
A-13	Hex Nut, M6	3	A-63	Gear	1
A-14	Drift	1	A-64	Shaft	1
A-15	Screw	1	A-65	Connecting Bend	1
A-16	Rack	1	A-66	Spring	1
A-17	Screw, M6x10	4	A-67	Screw	1
A-18	Fence	1	A-68	Headstock	1
A-19	Washer, 10	4	A-69	Screw	1
A-20	Wave Washer, 10	4	A-70	Ruler mark	1
A-21	Cap Screw, M10x25	4	A-71	Screw	1
A-22	Localizer	1	A-72	Setting Collar	1
A-23	Washer, 6	2	A-73	Screw, M4x12...	2
A-24	Screw, M6x15	2	A-74	Setting Rod	1
A-25	Screw, M6x10	2	A-75	Setting Collar	1
A-26	Pin	2	A-76	Screw, M6x25	1
A-27	Hex Nut, M10	1	A-77	Bushing	1
A-28	Washer, 10	1	A-78	Mistising Chisel And Bit	1
A-29	Screw	1	A-79	Pin	1
A-30	Screw	1	A-80	Clamp Plate	1
A-31	Setting Collar	1	A-81	Spring	1
A-32	Setting Rod	1	A-82	Spring Cover	1
A-33	Setting Collar	1	A-83	Handle	1
A-34	Hex Nut, M10	1	A-84	Cover	1
A-35	Washer, 10	1	A-85	Screw, M5x10	4
A-36	Screw	1	A-86	Cover Base	2
A-37	Screw, M6x15	1	A-87	C—Spring C-20	2
A-38	Screw	1	A-88	Handle	1
A-39	Screw, M4x12	1	A-89	Shaft	1
A-40	Depth Ruler	1	A-90	Clamping Block	1
A-41	Screw, M4x12	1	A-91	Nut ,M10	1
A-42	Screw, M6x15	1	A-92	Screw, M8x25	2
A-43	Screw, M6x15	2	A-93	Locking Shaft	1
A-44	Washer, 6	2	A-94	Handle	1
A-45	Localizer	1	A-95	Wood Table	1
A-46	Hex Nut, M12	1	A-96	Screw, M8x25	2
A-47	Washer, 12	1	A-97	Table	1
A-48	Spring	1	A-98	Washer , 10	2
A-49	Washer, 14	1	A-99	Screw, M10x25	2
A-50	Connecting Bend	1	A-100	Rack	1

CT096 – H.D MORTISING MACHINE

NO.	Description	Quantity	NO.	Description	Quantity
A-101	Screw, M6x10	3	A-112	Screw, M8x10	1
A-102	Gear	1	A-113	Collar	1
A-103	Drift	1	A-114	Lead Screw	1
A-104	Nut , M6	4	A-115	Lead Nut	1
A-105	Screw, M6x15	4	A-116	Washer 10	2
A-106	Pin	1	A-117	Screw, M10x25	2
A-107	Gear Shaft	1	A-118		
A-108	Collar	1	A-119		
A-109	Handwheel	1	A-120		
A-110	Screw, M8x10	1	A-121		
A-111	Handwheel	1	A-122		

CT096 – H.D MORTISING MACHINE

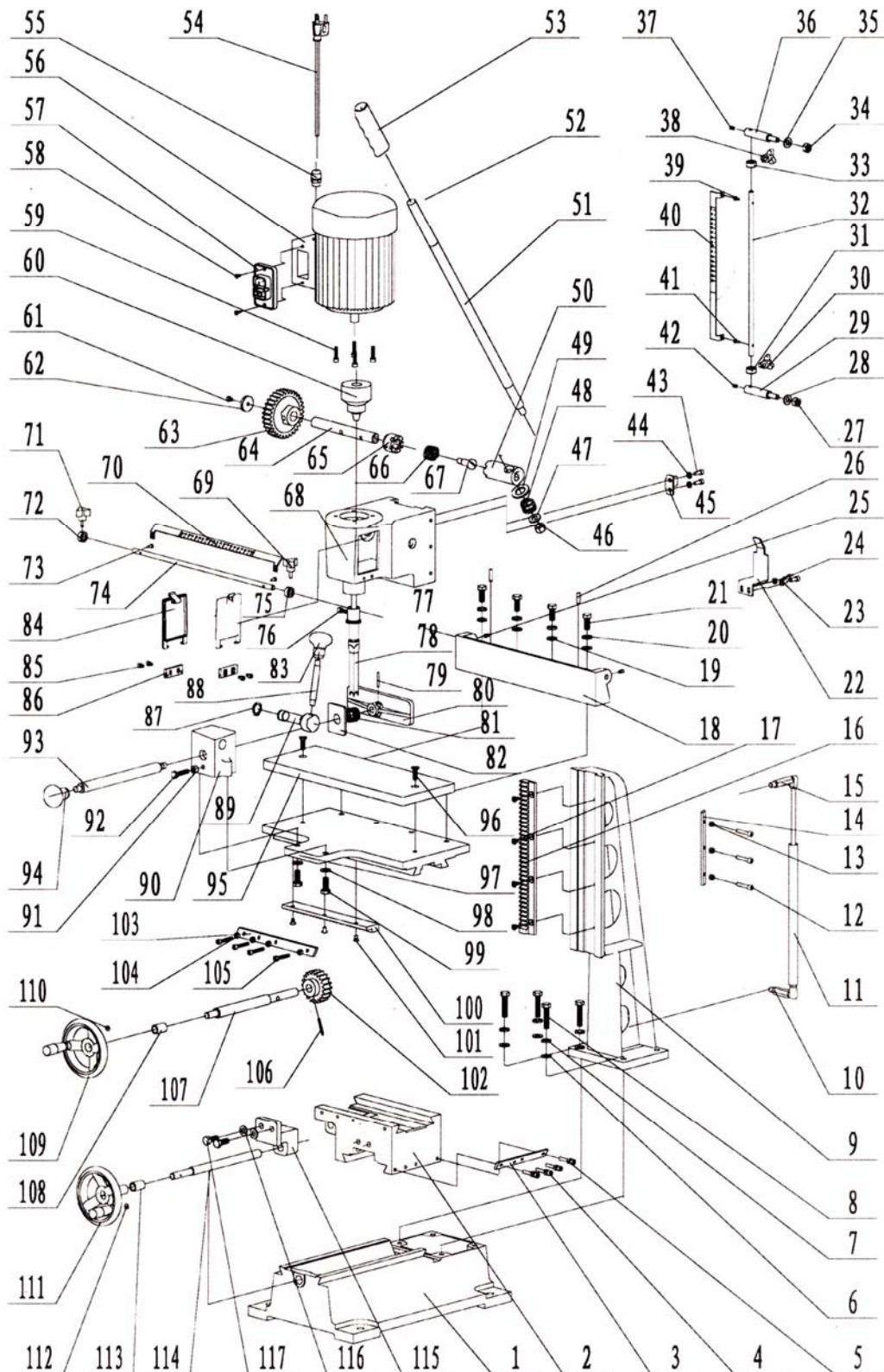

CT096 – H.D MORTISING MACHINE

PARTS LIST: Stand Assembly

NO.	Description	Quantity
B-1	Base	1
B-2	Stand	1
B-3	Door	1
B-4	Door Latch	1
B-5	Hex Nut, M10	4
B-6	Stand Base	4
B-7	Hex Nut, M10	4
B-8	Washer , 10	4
B-9	Wave Washer 10	4
B-10	Cap Screw, M12x40	4

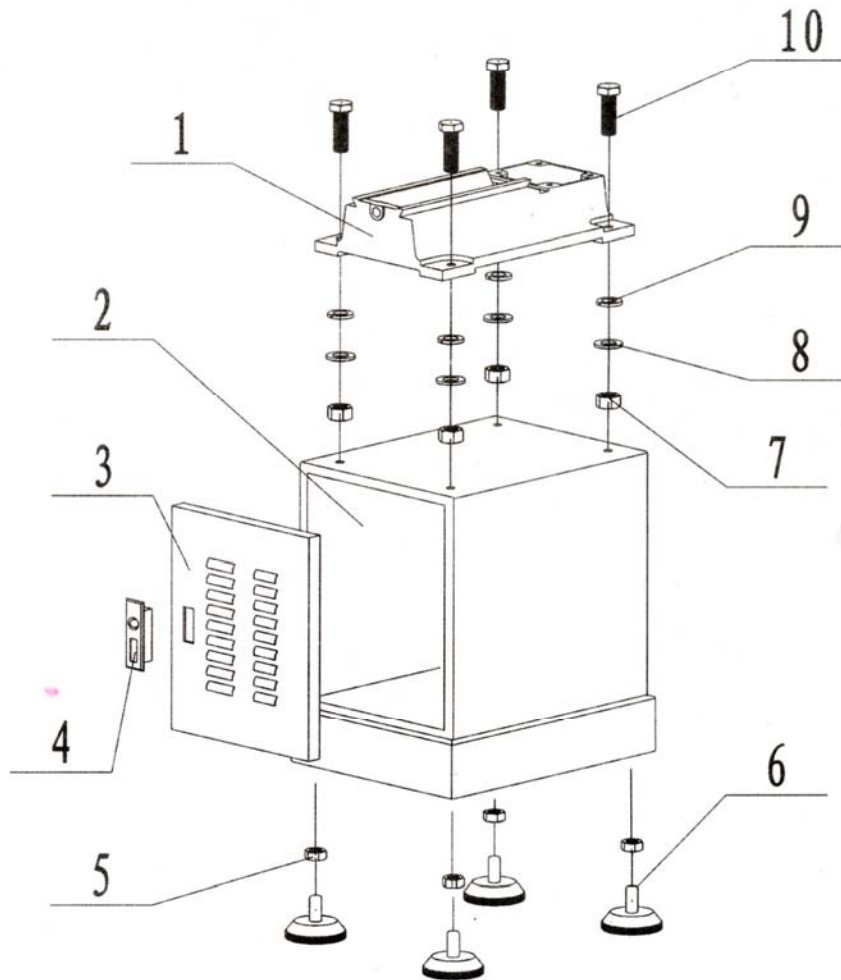

CT096 – H.D MORTISING MACHINE

PARTS LIST: Clamping Bar Assembly

NO.	Description	Quantity
C-1	Shaft	1
C-2	Setting Piece	1
C-3	Spring	1
C-4	Clamping body	1
C-5	C-Clip	1
C-6	Locking handle	1
G-7	Locking Screw	1
C-8	Pin	1
C-9	Stop Disc	1
C-10	Screw	1

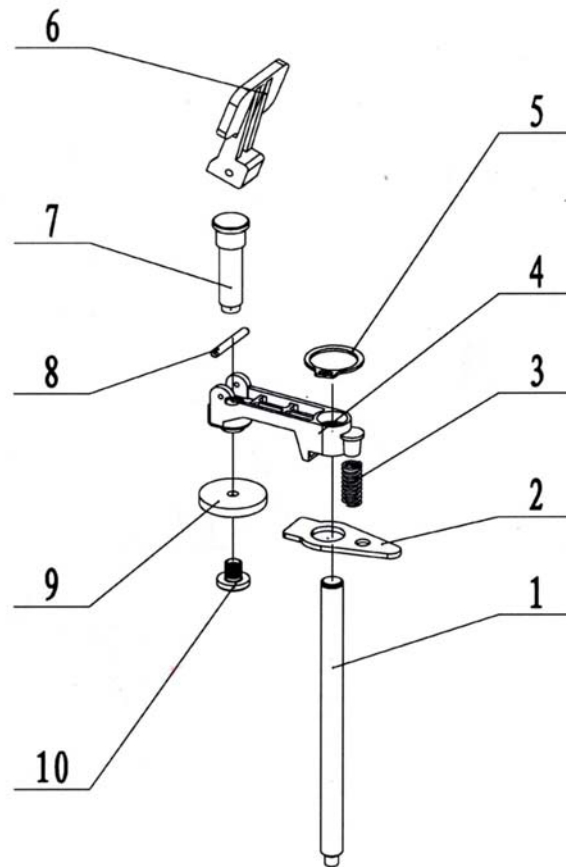

CT096 – H.D MORTISING MACHINE

PARTS LIST: Work Stop Assembly

NO.	Description	Quantity	NO.	Description	Quantity
D-1	Table	1	D-11	Setting Piece	1
D-2	Cap Screw M6x25	2	D-12	Spring	1
D-3	Rear Length Setting Rod	1	D-13	Cover	1
D-4	Wing Screw	1	D-14	Nut M8	1
D-5	Setting Piece	1	D-15	Stop Disc	1
D-6	Spring	1	D-16	Front Length Setting Rod And Stop Disc	1
D-7	Cover	1			
D-8	Length Setting Block	1	D-17		
D-9	C-Clip	1	D-18		
D-10	C-Clip	1	D-19		

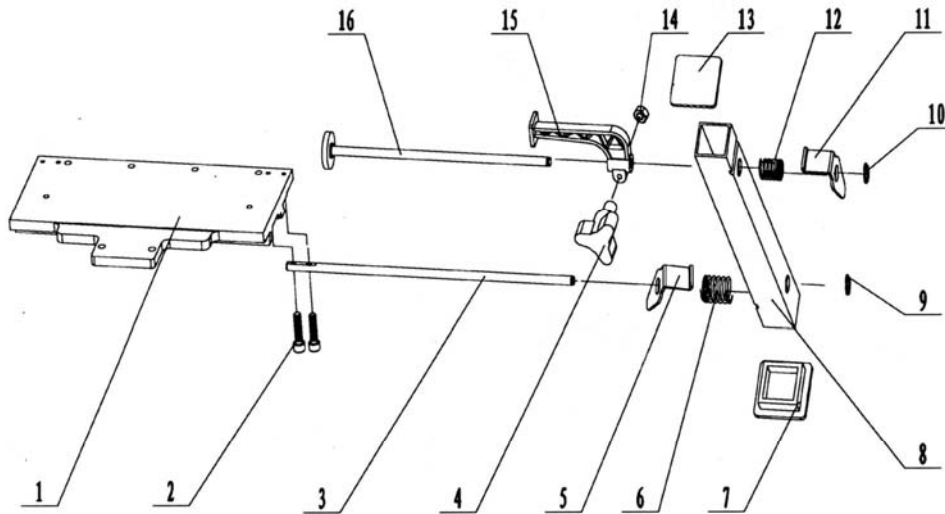



CRAFTEX 2 YEAR LIMITED WARRANTY

Craftex warrants every product to be free from defects in materials and agrees to correct such defects where applicable. This warranty covers **two years** for parts and 90 days for labour (unless specified otherwise), to the original purchaser from the date of purchase but does not apply to malfunctions arising directly or indirectly from misuse, abuse, improper installation or assembly, negligence, accidents, repairs or alterations or lack of maintenance.

Proof of purchase is necessary.

All warranty claims are subject to inspection of such products or part thereof and Craftex reserves the right to inspect any returned item before a refund or replacement may be issued.

This warranty shall not apply to consumable products such as blades, bits, belts, cutters, chisels, punches etceteras. Craftex shall in no event be liable for injuries, accidental or otherwise, death to persons or damage to property or for incidental contingent, special or consequential damages arising from the use of our products.

RETURNS, REPAIRS AND REPLACEMENTS

To return, repair, or replace a Craftex product, you must visit the appropriate Busy Bee Tools showroom or call 1-800-461-BUSY. Craftex is a brand of equipment that is exclusive to Busy Bee Tools.

For replacement parts directly from Busy Bee Tools, for this machine, please call 1-800-461-BUSY (2879), and have your credit card and part number handy.

- All returned merchandise will be subject to a minimum charge of 15% for re-stocking and handling with the following qualifications.
- Returns must be pre-authorized by us in writing.
- We do not accept *collect* shipments.
- Items returned for warranty purposes must be insured and shipped pre-paid to the nearest warehouse
- Returns must be accompanied with a copy of your original invoice as proof of purchase. Returns must be in an un-used condition and shipped in their original packaging a letter explaining your reason for the return. Incurred shipping and handling charges are not refundable.
- Busy Bee will repair or replace the item at our discretion and subject to our inspection.
- Repaired or replaced items will be returned to you pre-paid by our choice of carriers.
- Busy Bee reserves the right to refuse reimbursement or repairs or replacement if a third party without our prior authorization has carried out repairs to the item.
- Repairs made by Busy Bee are warranted for 30 days on parts and labour.
- Any unforeseen repair charges will be reported to you for acceptance prior to making the repairs.
- The Busy Bee Parts & Service Departments are fully equipped to do repairs on all products purchased from us with the exception of some products that require the return to their authorized repair depots. A Busy Bee representative will provide you with the necessary information to have this done.
- For faster service it is advisable to contact the nearest Busy Bee location for parts availability prior to bringing your product in for repairs.

