



CX300

3-HP DELUXE SHAPER

User Manual



COPYRIGHT © 2010 BY CRAFTEX INDUSTRIES INC.

NO PORTION OF THIS MANUAL MAY BE PRODUCED WITHOUT
THE WRITTEN CONSENT OF CRAFTEX INDUSTRIES INC.



TABLE OF CONTENTS

General Safety Instructions.....	3
Specific Safety Instructions.....	4
CX300 Features.....	5
Physical Features	6
Set Up.....	7
Un-Packing	7
Proper Grounding	8
Assembly	9
Spindle	10
Table Insert.....	11
Fence Assembly	12
Cutter-Head Guard	12
Connecting to a Dust Collector	13
Basic Controls.....	14
Test Run	14
Forward / Reverse Switch.....	15
Installing the Cutter	15
Spindle Height	16
Fence Adjustment.....	16
Speed Changes	17
Replacing the V-Belt	17
Tensioning the V-Belt.....	18
Shaping with the Fence	18
Free Hand Shaping.....	19
Using Collars	19
Maintenance	20
Lubrication	20
Cleaning.....	20
V-Belt Inspection.....	20
Troubleshooting	21
Parts Breakdown & List.....	22-31
Warranty	32

GENERA**LSAFETY** INSTRUCTIONS FOR MACHINES

Extreme caution should be used when operating all power tools. Know your power tool, be familiar with its operation, read through the user manual and practice safe usage procedures at all times.

- ❖ **ALWAYS** read and understand the user manual before operating the machine.
- ❖ **CONNECT** your machine **ONLY** to the matched and specific power source.
- ❖ **ALWAYS** wear safety glasses respirators, hearing protection and safety shoes, when operating your machine.
- ❖ **DO NOT** wear loose clothing or jewelry when operating your machine.
- ❖ **A SAFE ENVIRONMENT** is important. Keep the area free of dust, dirt and other debris in the immediate vicinity of your machine.
- ❖ **BE ALERT! DO NOT** use prescription or other drugs that may affect your ability or judgment to safely use your machine.
- ❖ **DISCONNECT** the power source when changing drill bits, hollow chisels, router bits, shaper heads, blades, knives or making other adjustments or repairs.
- ❖ **NEVER** leave a tool unattended while it is in operation.
- ❖ **NEVER** reach over the table when the tool is in operation.
- ❖ **ALWAYS** keep blades, knives and bits sharpened and properly aligned.
- ❖ **ALL OPERATIONS MUST BE** performed with the guards in place to ensure safety.
- ❖ **ALWAYS** use push sticks and feather boards to safely feed your work through the machine and clamp the work-piece (when necessary) to prevent the work-piece from any unexpected movement.
- ❖ **ALWAYS** make sure that any tools used for adjustments are removed before operating the machine.
- ❖ **ALWAYS** keep the bystanders safely away while the machine is in operation.
- ❖ **NEVER** attempt to remove jammed cutoff pieces until the saw blade has come to a full stop.

CX300 – DELUXE SHAPER

SPECIFIC SAFETY INSTRUCTIONS

- ❖ Read and follow all the instructions and safety precautions in the user manual before setup or use.
- ❖ For the protection of your eyes, always wear safety glasses, goggles or face shield while operating the shaper.
- ❖ Never place your fingers or hands in the line of cut. If you slip, your hands or fingers may come into contact with the cutter. Always use a push stick when feeding stock against the cutter.
- ❖ Make sure the keyed washer is mounted directly under the spindle nuts.
- ❖ All guards must be in place while operating the shaper to ensure safety.
- ❖ Always feed the stock smoothly against the rotation of the cutter.
- ❖ Do not force the machine. It will perform a better job at a rate for which it is designed.
- ❖ Allow the motor to reach the full speed before feeding stock against the cutter.
- ❖ Use the overhead guard when adjustable fence is not in place.
- ❖ Make sure before making any adjustments, the switch is in the “OFF” position and the cord is un-plugged.
- ❖ Never leave the shaper unattended while it is running.
- ❖ Always use the cutters designed to be used with CX300 and similar shapers.
- ❖ Do not expose the shaper to rain or use in damp locations.
- ❖ Clean and sharp tools give safer and better performance. Dull cutters can cause kick backs and excessive chatter. Always check the cutter and other parts for proper adjustment before cutting operation.
- ❖ Always make sure that your shaper is in a stable position. Cutting heavy, long stock may alter the stability of the shaper. In the event that this may occur, the shaper should be firmly bolted to the floor.
- ❖ Do not wear loose clothing, neckties, jewelry or gloves that can get caught in moving parts. Confine long hair and keep sleeves above the elbow.
- ❖ Always use a feather board and/or hold-downs to support your work-piece when necessary.
- ❖ Make sure you have read and understood all the safety instructions in the manual and you are familiar with your shaper, before operating it. If you fail to do so, serious injury could occur.

WARNING

The safety instructions given above can not be complete because the environment in every shop is different. Always consider safety first as it applies to your individual working conditions.



CX300 – DELUXE SHAPER

FEATURES

MODEL CX300 – 3-HP DELUXE SHAPER

As part of the growing line of Crafttex woodworking equipment, we are proud to offer the CX300 a 3-HP Deluxe Shaper. The Crafttex name guarantees Craft Excellence. By following the instructions and procedures laid out in this user manual, you will receive years of excellent service and satisfaction. The CX300 is a professional tool and like all power tools, proper care and safety procedures should be adhered to.

- ❖ Motor 3-HP, 220-V, 12.8 Amp, Single Phase TEFC Motor
- ❖ Drive System “V” Belt Drive
- ❖ Table Size..... 31” x 28-1/2” (with extension table)
- ❖ Floor to Table Height 34”
- ❖ Miter Gauge..... T-Slot Miter Gauge
- ❖ Deluxe Fence Plate Size 14-1/4” x 4-1/4” x 11/16”
- ❖ Dust Collection Port..... One 5” Port
- ❖ Insert Opening Diameters..... 1-3/8”, 2-3/4”, 4” and 5-1/2”
- ❖ Spindle Size..... 3/4” and 1”
- ❖ Spindle Speed 7100 / 11000 RPM
- ❖ Capacity Under Nut 2-1/2”
- ❖ Spindle Travel..... 3”
- ❖ Router Bit Adapter 1/2” with a 1/4” Sleeve Insert
- ❖ Switch Magnetic and Reversing Switch
- ❖ Footprint 23-1/4” x 20-3/4”
- ❖ Overall Height..... 48”
- ❖ Net Weight..... 370 lbs

CX300 3-HP DELUXE SHAPER PHYSICAL FEATURES

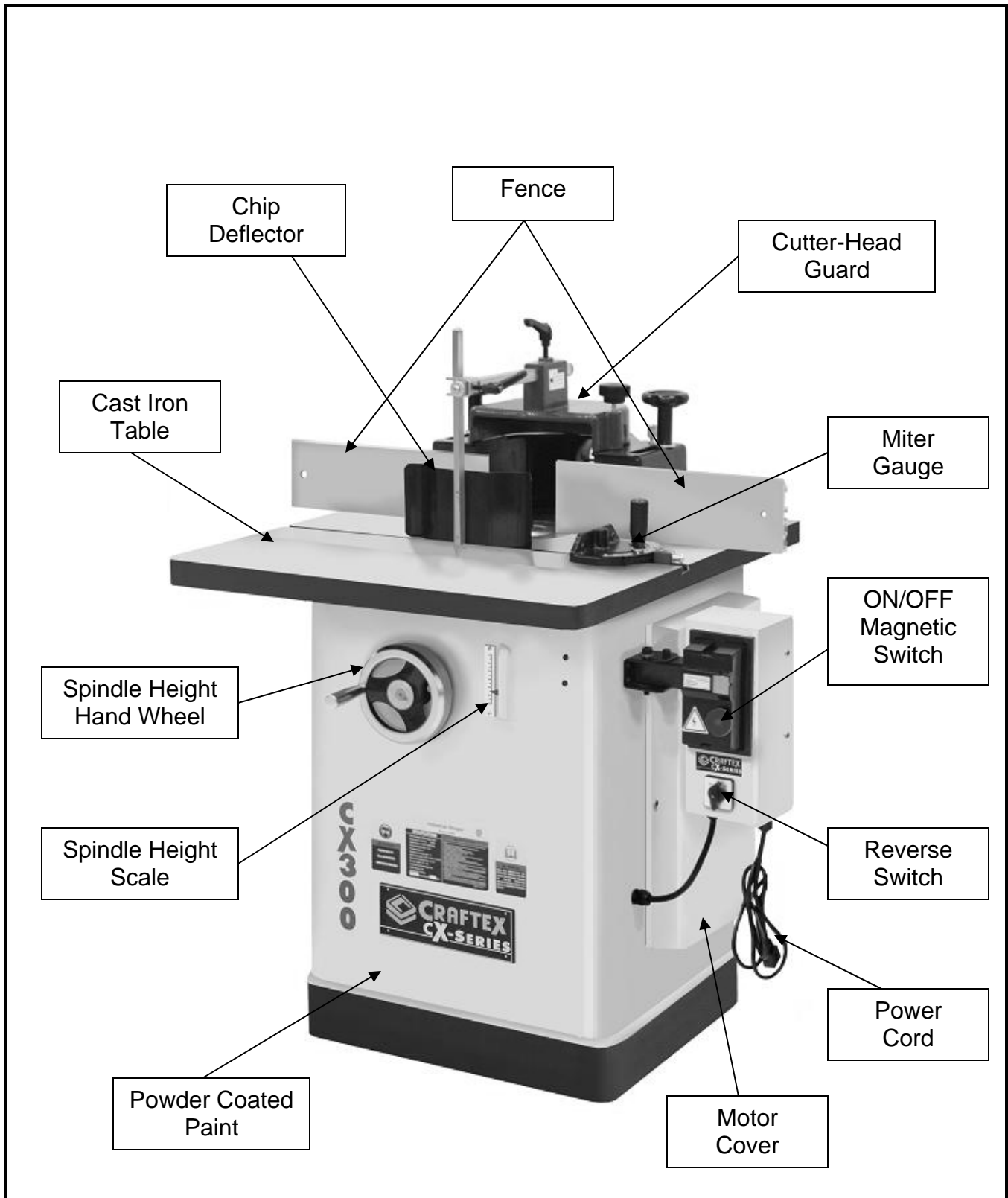

SETUP

Before setting up your machine you should read and understand the instructions given in this manual.

The unpainted surfaces of this shaper are coated with a rust preventive waxy oil and you will want to remove this before you begin assembly. Use a solvent cleaner that will not damage painted surfaces.

WARNING

CX300 is a very heavy machine, do not over-exert yourself. For safe moving method use fork truck or get the help of an assistant or friend.

UNPACKING

The machine is properly packaged and shipped completely in crates for safe transportation. When unpacking, carefully inspect the crates and ensure that nothing has been damaged during transit. Open the crates and check that the machine and the parts are in good condition.

NOTE:

While doing inventory, if you can not find any part, check if the part is already installed on the machine. Some of the parts come assembled with the machine because of shipping purposes.

When setting up your machine, you will want to find an ideal spot where your shaper will most likely be positioned most of the time. Consider your complete work environment as well as working comfortability with the shaper, before placing your machine in the ideal spot.

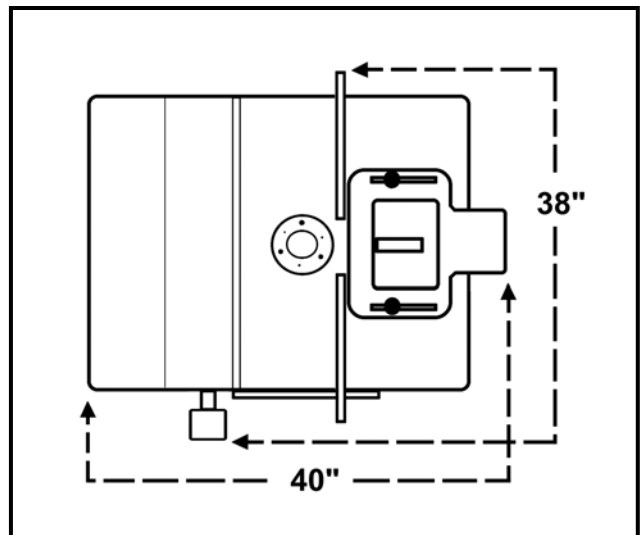

Figure-1 Foot print for CX300

PROPER GROUNDING

Grounding provides a path of least resistance for electric current to reduce the risk of electric shock.

CX300 is equipped with a 220-volts, single phase motor which features a 3-conductor cord and a 3-prong grounded plug to fit a grounded type receptacle. Do not remove the grounding prong to fit it into a 2-pronged outlet. Always check with a qualified electrician if you are in doubt.

Make sure the cord is plugged into a properly installed and grounded power outlet.

To prevent electrical hazards, have a qualified electrician ensure that the line is properly wired.

This machine is for use on a normal 220-volt circuit and is factory-equipped with a specific electric cord and plug to permit connection to a proper electric circuit. Make sure that the appliance is connected to an outlet having the same configuration as the plug. If an adaptor plug is used, it must be attached to the metal screw of the receptacle.

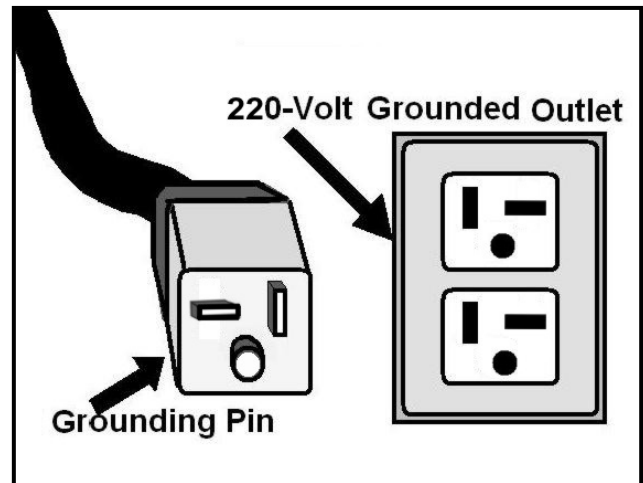

Figure-2 220-Volts outlet for CX300

It is strongly recommended not to use extension cords with your CX300. Always try to position your machine close to the power source so that you do not need to use extension cords.

In case if you really find it necessary to use an extension cord, make sure the extension cord does not exceed 50-feet in length and the cord is 14-gauge to prevent motor damage.

WARNING

Improper connection of the equipment-grounding conductor can result in a risk of electric shock. Check with a qualified electrician if you are in doubt as to whether the outlet is properly grounded.

ASSEMBLY

Read the manual and follow the instructions given in this manual to assemble your CX300.

Take the magnetic switch out of the cabinet and loosen the bolt securing the shipping brace, and remove the brace. Reinstall the bolt and washers and save the shipping brace.

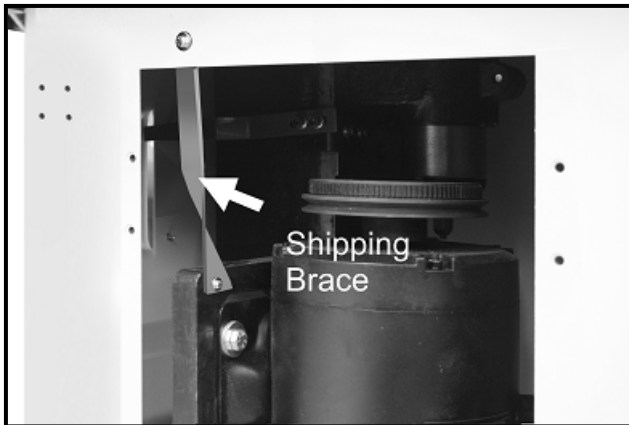

Figure-3 Shipping brace location

Attach the motor cover using six hex screws and washers provided. See figure-4.



Figure-4 Installing the motor cover

Slide the spindle height hand wheel onto the hand wheel shaft and secure it using set screw provided. See figure-5.

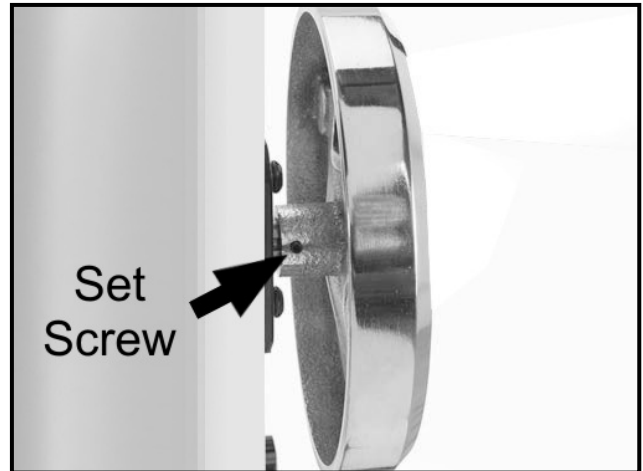

Figure-5 Securing the blade tilt hand wheel

Thread the handle onto the hand wheel and tighten using a proper size wrench.

The switch is designed to be mounted on a swivel bracket so that it can be set in various positions.

Attach the smaller bracket to the cabinet using four screws and four washers. Take the larger bracket and align it to the smaller bracket with the larger hole and secure it using M10x65mm socket head cap, two flat washers and one M10 hex nut.

Position the swivel bracket to the desired position, and aligned with one of the three holes on the smaller bracket. Secure it using one M8x20mm socket head cap screw. See figure-6.

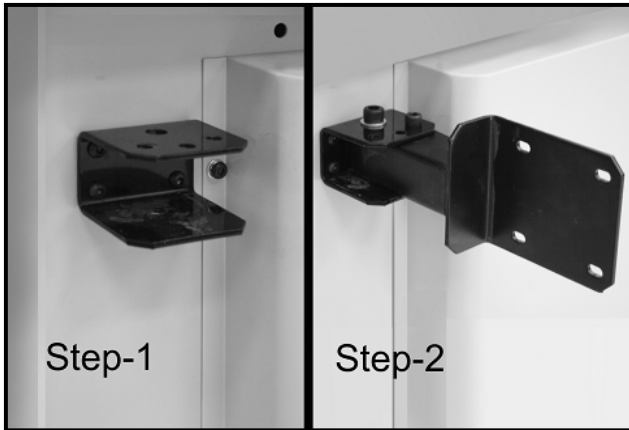

Figure-6 Installing the switch box swivel bracket

Now, attach the switch box to the swivel bracket and secure it using screws washers and lock washers as shown in figure-7.

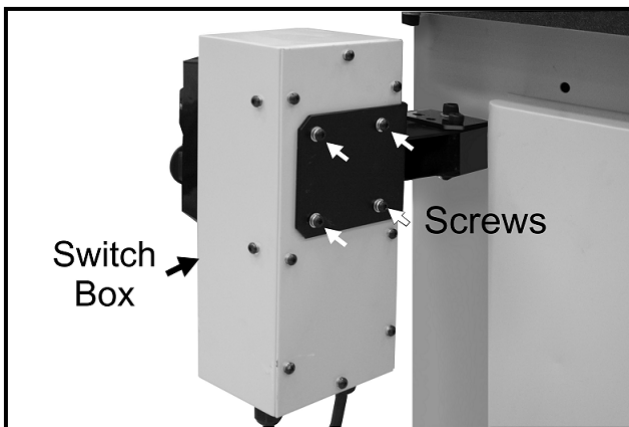

Figure-7 Installing switch box

Install the extension wing to main table using three M10x35mm socket head cap screws, flat washers and lock washers provided. Do not fully tighten the screws at this time.

Place a straight-edge across the extension wing and the main table and adjust the extension wing so that the extension wing surface is flush with the surface of the main table and tighten the screws.

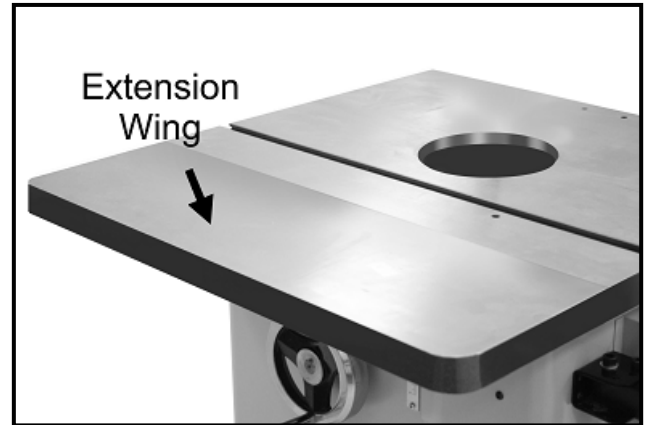

Figure-8 Installing the extension wing

SPINDLE

The CX300 comes with two spindles 3/4" and 1". Each spindle is designed to work with different size cutters. When installing the spindle, make sure the nuts are tightened properly for safe operation.

To install the spindle:

Make sure the switch is "OFF" and the cord is un-plugged from the power source.

Remove the hex nut threaded on the spindle and draw bar nut from the draw bar. Thread the short threaded end of the draw bar into the spindle and tighten.

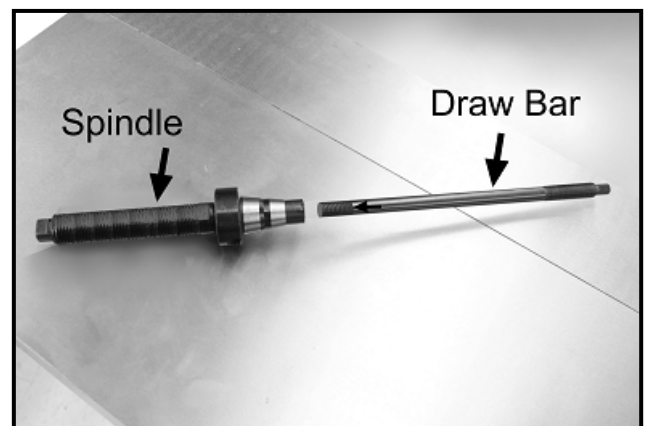

Figure-9 Spindle and draw bar

Now slide the draw bar with the spindle into the quill and make sure that keyway in the spindle is aligned with the tab on the quill.

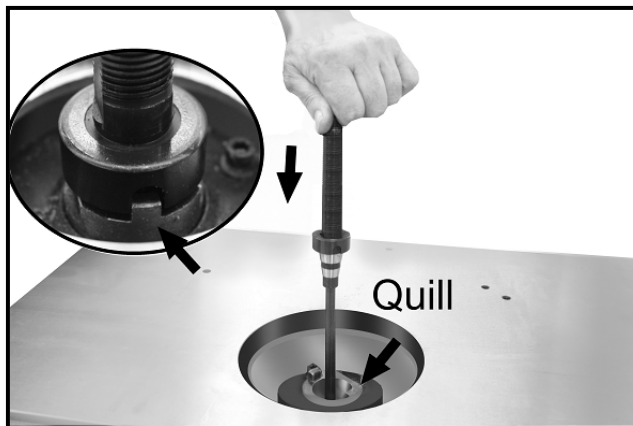

Figure-10 Inserting the draw bar into the quill

Use a wrench to hold the top part of the spindle while tightening the draw bar nut on the draw bar from the bottom as shown in figure-11.

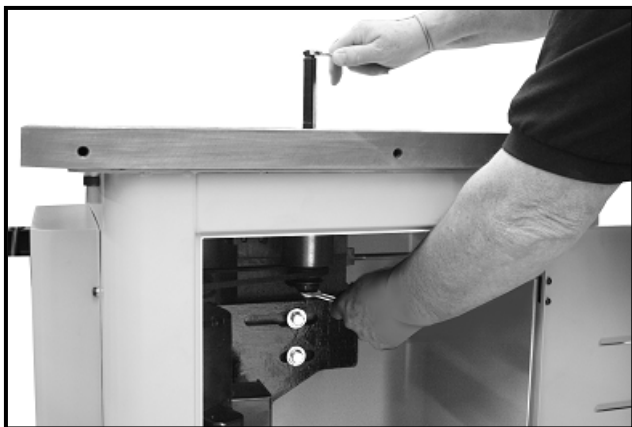

Figure-11 Tightening the draw bar nut

IMPORTANT

Make sure the spindle keyway is aligned with the tab on the quill and the spindle sits properly on the quill for safe operation.

Thread the spindle height lock knob through the hole on the side of cabinet opposite to the motor cover. See figure-15.

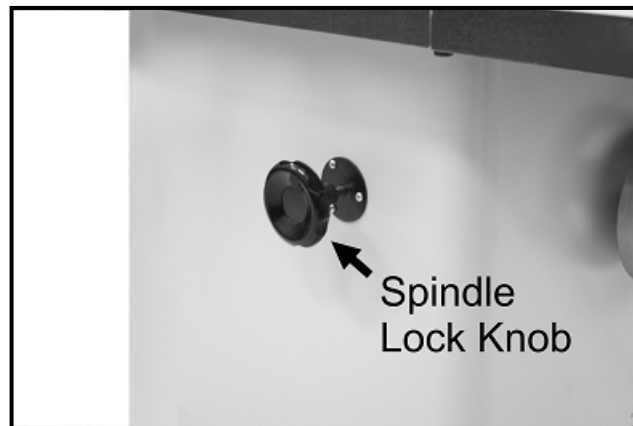

Figure-12 Installing the spindle lock knob

TABLE INSERT

Place the table insert, over the spindle, on the table and make sure the insert is flush with the table surface. Secure the insert using 3 screws and washers provided.

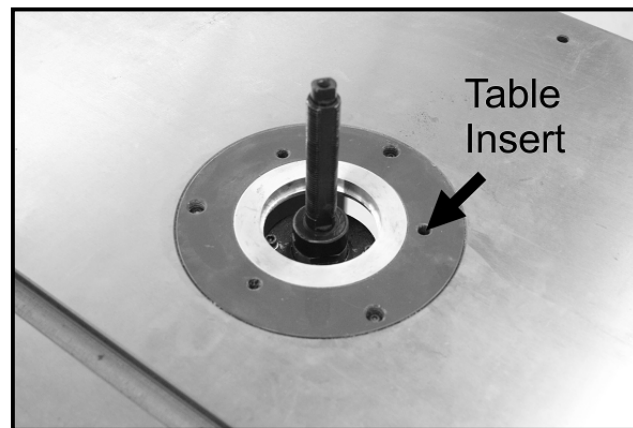

Figure-13 Installing the table insert

Make sure to clean any dust or dirt on the spindle opening before installing the table insert so that the table insert is flush with the table surface when installed.

FENCE ASSEMBLY

The CX300 comes with two 15" x 4" independent fences which attach to the dust hood.

To install the fence:

The fence blocks come attached to the dust hood. Attach the lock blocks to the fence blocks using lock levers and washers. See figure-14. Do not tighten the lock lever.

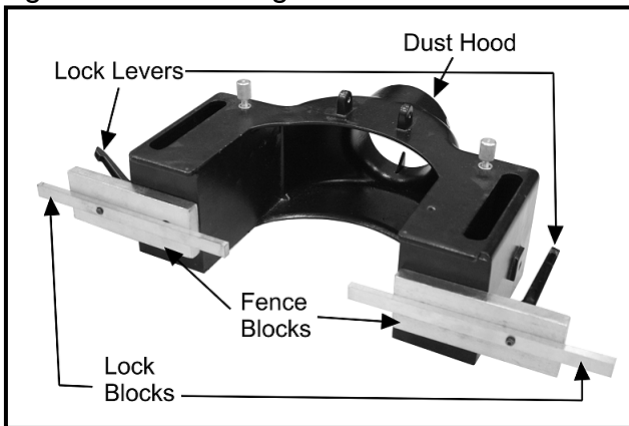

Figure-14 Attaching the fence blocks

Slide the each fence piece onto the lock blocks, through the slot at the back of the fence piece. Tighten the lock levers to secure the fence in place. See figure-15.

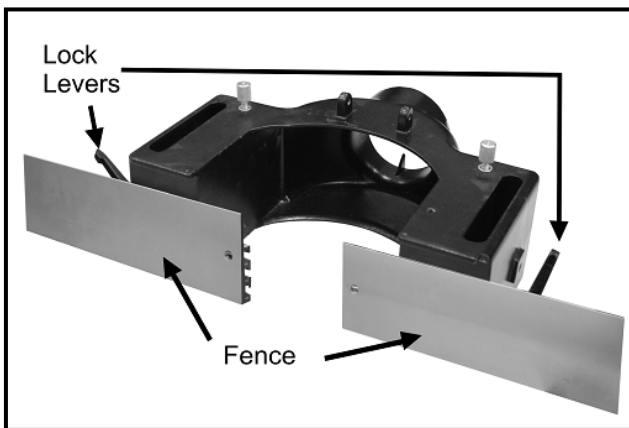

Figure-15 Installing the fence

Now, take the dust hood with the fence assembly attached to it, and place it on the table. Use the two lock knobs to secure it by threading the lock knobs into the holes located slightly behind the spindle opening.

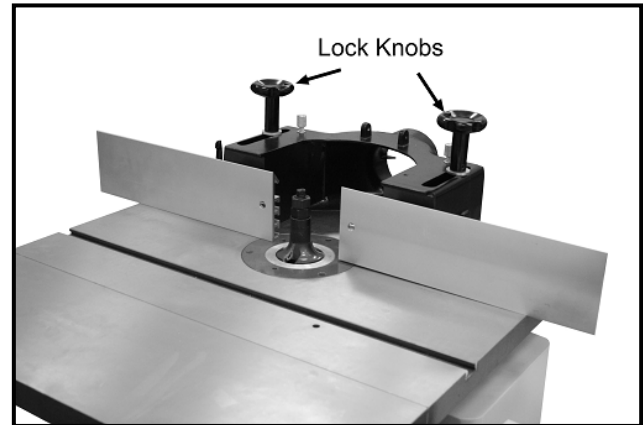

Figure-16 Installing the dust hood on the table

When you want to remove the fence assembly, follow the same procedure in reverse.

CUTTER HEAD GUARD

Install the top cover on the top of the dust hood with the help of an M5x100 cap screw and an M5 lock nut. Thread the lock knob on the cutter head top cover to lock it in place as shown in figure-17.

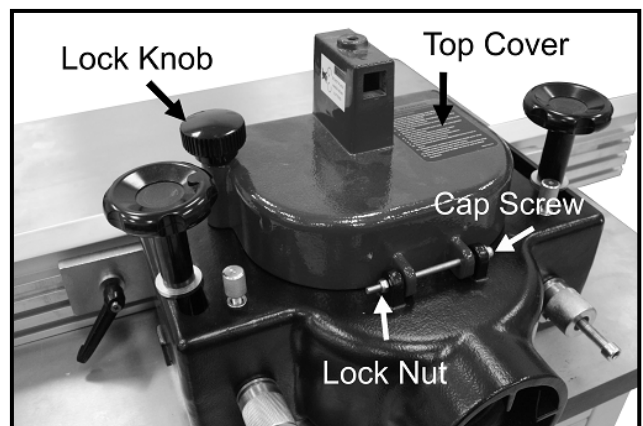

Figure-17 Installing the cutter head guard

Slide the support bar into the hole on the top cover and lock it in position using the lock lever provided. See figure-18.

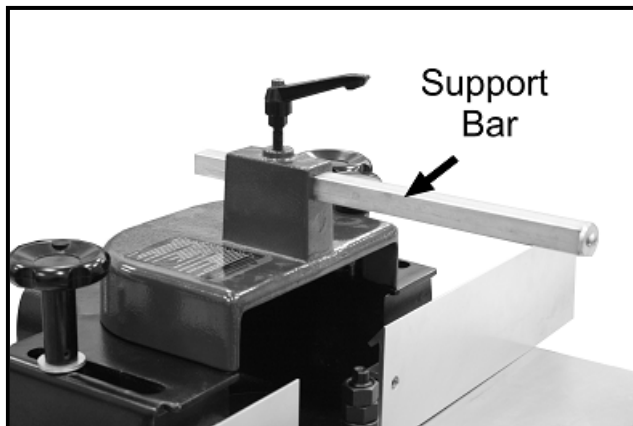

Figure-18 Support bar for guards

Now select the guard according to the job you are performing and install the guard as shown in figure-19.

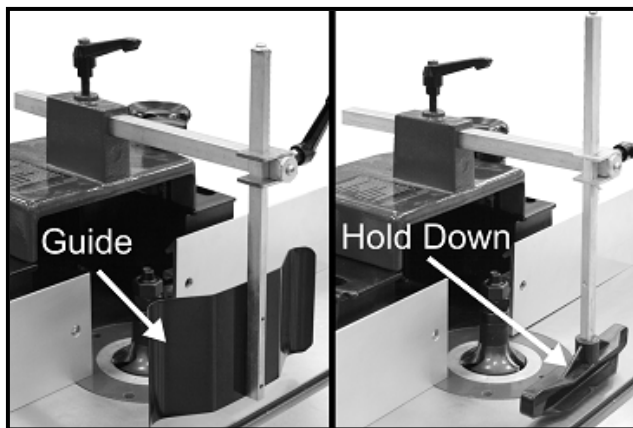

Figure-19 Installing guards on the support bar

WARNING

The guards should be as close to the cutter as possible without interfering with the travel of the work-piece or cutter.

CONNECTING TO A DUST COLLECTOR

CX300 features a 5" diameter dust port to connect to a dust collector.

When connecting to a dust collector, use a proper sized hose and make sure all the connections are sealed tightly.

It is recommended to use a proper sized dust collector with the CX300 to ensure adequate dust collection.

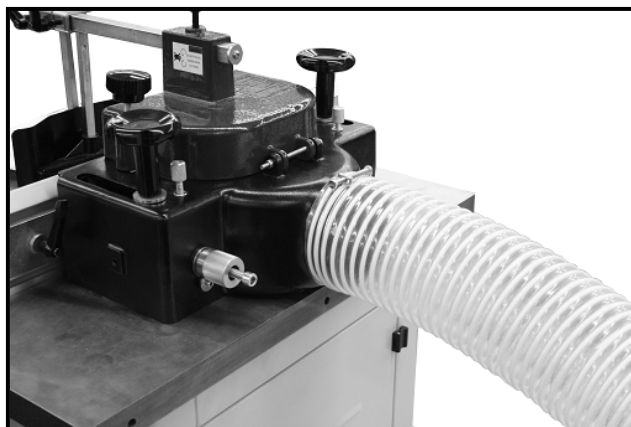

Figure-20 5" Hose clamped to the dust port

WARNING

The fine dust particles produced by the woodworking machines can go inside your lungs and cause serious respiratory problems. Make sure to wear a dust mask and the machine is connected to a proper dust collection system while operation.

BASIC CONTROLS

The basic controls of this machine are shown in the figure-21. Use the figure and read the text to understand what the basic controls of your CX300 are.

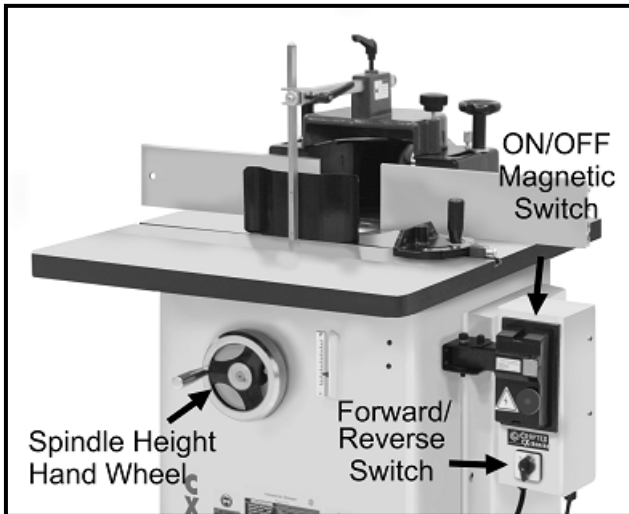

Figure-21 Basic controls on CX300

ON/OFF Magnetic Switch

The magnetic switch on your CX300 has a green button to turn the machine “ON” and a red button to turn the machine “OFF”.

Forward/Reverse Switch

The forward/reverse switch is used to control the direction of rotation of the cutter head.

Spindle Height Hand Wheel

The spindle height hand wheel is used to raise and lower the spindle.

TEST RUN

Once you have assembled your machine completely, it is now time for a test run to make sure that the machine works properly and is ready for operation.

During the test run if there is any unusual noise coming from the machine or the machine vibrates excessively, stop the machine immediately and disconnect from the power source and investigate to find out the problem with your machine. See page-21 for Troubleshooting.



**READ THE
MANUAL**

Before starting the shaper, make sure that you have read and understood the manual and you are familiar with the functions and safety features on this machine. Failure to do so may cause serious personal injury.

During the test run check the safety features on the machine and make sure all the safety features work properly.

WARNING

The safety instructions given in this manual can not be complete because the environment in every shop is different. Always consider safety first as it applies to your individual working conditions.

FORWARD/REVERSE SWITCH

The CX300 is equipped with a forward / reverse switch which controls the direction of rotation of the cutter.

Most of the jobs are done with the forward rotation of the cutter but some times if it is necessary, you will want to flip the cutter on the spindle and reverse the cutter rotation to perform some specific jobs.

The button on the switch can be turned and set on any of the three positions; Forward, Off and Reverse.

When the switch is in the “Forward” position, the spindle will rotate in counter-clockwise direction and when in the “Reverse” position, the spindle will rotate in clockwise direction. When the switch is set on “Off”, the spindle will stop moving.



Figure-22 Forward / Reverse Switch

WARNING

Before operating the shaper, check the direction of the rotation of the cutter. Cutters rotating backwards can cause unsafe conditions.

INSTALLING THE CUTTER

The CX300 operates at speeds of 7100 and 11000 RPM. Make sure to use the proper sized cutters with proper sized spindles on your CX300 to ensure safe operation.

To install the cutter:

Turn the machine “OFF” and make sure the cord is un-plugged from the power source.

Loosen the two lock knobs securing the dust hood and on the table and move the dust hood away from the spindle.

Place an appropriate spacer or collar on the spindle for support. (If needed)

Place the cutter on the spindle and make sure the orientation of the cutter is correct for your cutting application.

Place the spacers or collar (as needed) and screw the nut and the lock nut on the top. See figure-23.

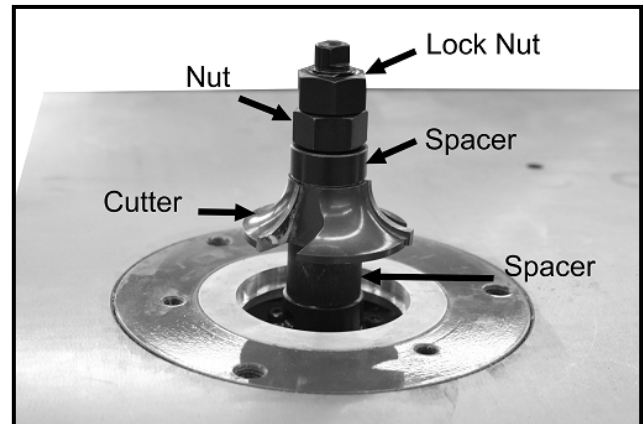

Figure-23 Installing the cutter

Hold the spindle with a wrench from the top for leverage and tighten the nuts using another wrench.

SPINDLE HEIGHT

To adjust the spindle height:

Loosen the spindle lock knob located on the side of the cabinet. See figure-24.

Rotate the spindle height hand wheel to raise or lower the spindle and tighten the lock back.

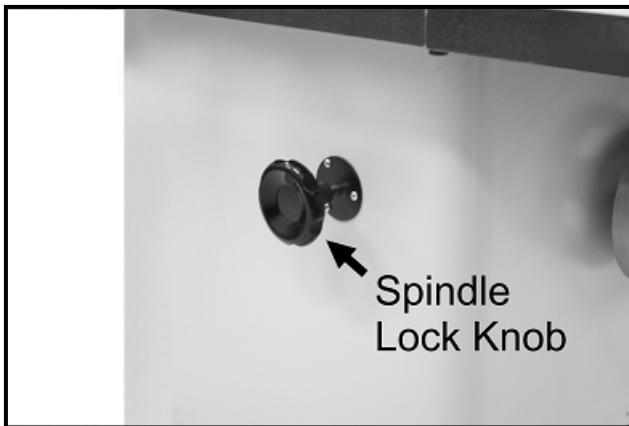

Figure-24 Spindle lock knob

FENCE ADJUSTMENT

The fence is two pieces and each piece can be adjusted side ways to allow a wider opening at the cutter. The fence can also be adjusted back and forward.

To adjust the fence side ways:

Turn the switch "OFF" and make sure the cord is un-plugged from the power source.

Loosen the lock levers located at the back, holding the fence to the fence blocks (part# 720).

When the fence is loose, it will be free to slide side on the lock block (part# 719).

Adjust the fence to your desired position and tighten the lock levers.

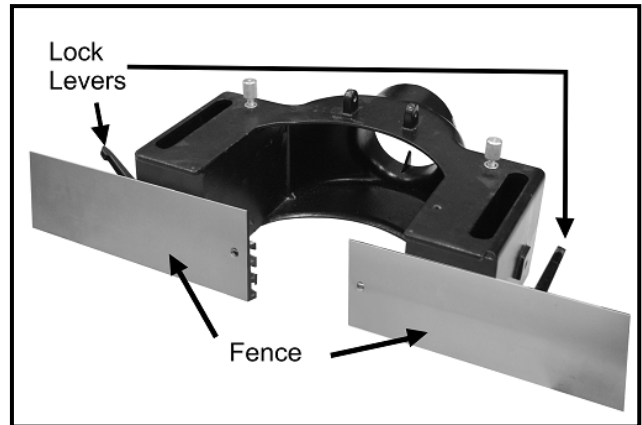

Figure-25 Fence assembly

To adjust the fence back or forward on the table:

Simply, loosen the lock knobs (part# 726) securing the dust hood on the table and move the dust hood back or forward to your desired position and tighten the lock knobs back.

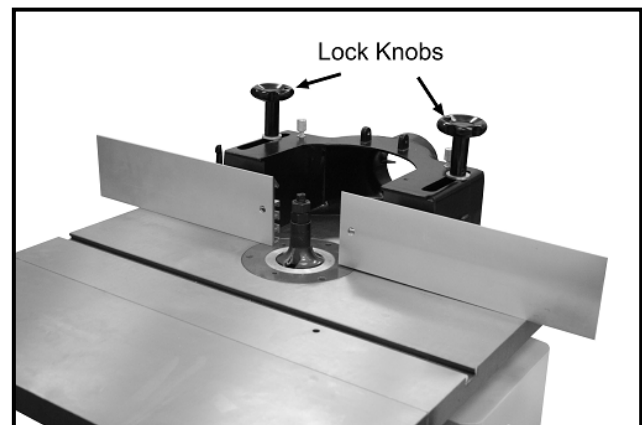

Figure-26 Loosening the lock knobs to adjust the fence forward or backwards on the table

SPEED CHANGES

The CX300 operates at speeds of 7100 and 11000 RPM.

To change the speed:

Turn the switch "OFF" and make sure the cord is un-plugged from the power source.

Open the cabinet door and loosen the two bolts on the motor mounting bracket as shown in figure-27.

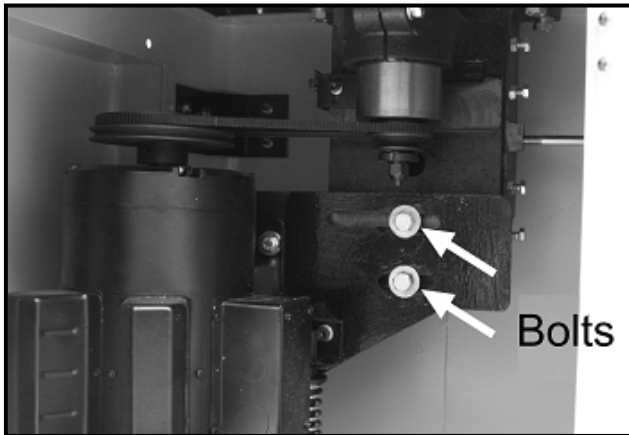

Figure-27 Loosening the hex bolts

Push the motor towards the spindle pulley to release tension on the V-belt.

Line up the V-belt on the pulleys as shown in figure-28 to operate the machine at 7100 or 11000 RPM.

WARNING

Make sure the machine is turned off and the cord is disconnected from the power source before servicing and removing/replacing any components on the machine.

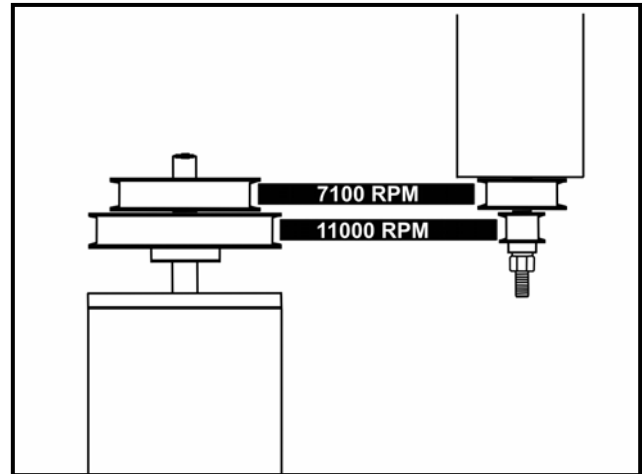

Figure-28 Belt position on the pulleys for speed changes

Push the motor away from the spindle to tension the V-belt. There should be approximately 1/4" deflection at the center of the V-belt when pressed at with a finger. See page-18 for details.

Retighten the bolts and close the cabinet door.

REPLACING THE V-BELT

The V-belt stretches with use and should be checked regularly and replaced if needed.

To change the V-belt on your CX300:

Turn the switch "OFF" and make sure the cord is un-plugged from the power source.

Open the cabinet door and loosen the two bolts shown in figure-27. Push the motor towards the spindle to release the tension on the belt.

Remove the belt and replace it with a new one. Move the motor back to its position

and tension the V-belt. Tighten the bolts and close the cabinet door.

TENSIONING THE V-BELT

There should be 1/4" of deflection when applying moderate pressure with your finger on the V-belt. See figure-29.

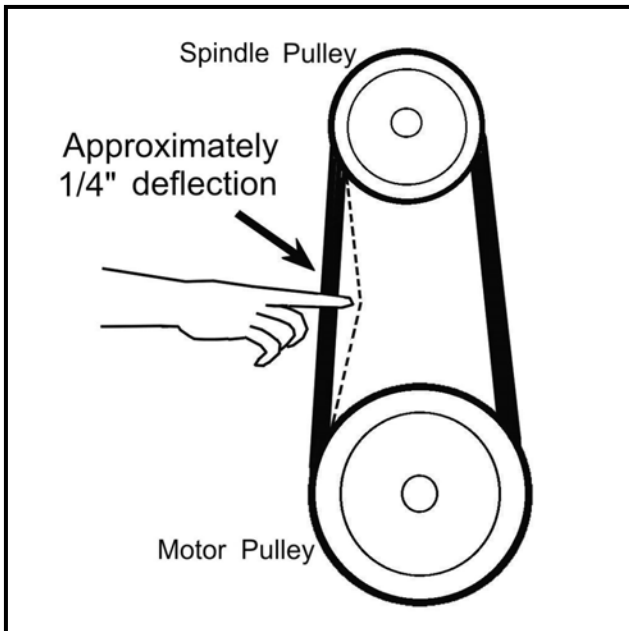

Figure-29 Correct tension on the V-belt

If the deflection is more or less, loosen the two bolts on the motor mounting bracket and push the motor towards or away from the spindle to get 1/4" deflection on the V-belt.

When the V-belt is tensioned correctly, tighten the bolts on the motor bracket and close the cabinet to secure the bracket.

SHAPING WITH THE FENCE

Using the fence is the safest method of shaping. Most operations that use the fence for support can be performed by following the guidelines below:

If performing a cut where a portion of the edge of the work-piece is not touched by the cutter-head, both sides of the fence are positioned at the same depth.

When performing a cut where the entire edge of the work-piece is removed, the fence must be positioned differently. If the fence halves are kept in line, once the work-piece passes through the cutter-head, the shaped edge would no longer be supported against the fence. To prevent this, the out-feed side of the fence must be positioned further out to compensate for the material being removed. Advance the out-feed side of the fence equal to the amount of material being removed.

If using a miter gauge, the in-feed side of the fence must be parallel with the miter slot. Also make sure that the other fence piece is positioned out of the way so that it does not contact the work-piece after it passes through the cutter-head.

WARNING

When performing free hand shaping, the fence is removed which exposes the cutter and increase the risk of injury.

FREE HAND SHAPING

To set up the shaper for free hand shaping:

Turn the switch “OFF” and make sure the cord is un-plugged from the power source.

Remove the fence assembly and insert the starting pin in the most suitable hole on the insert. See figure-30.

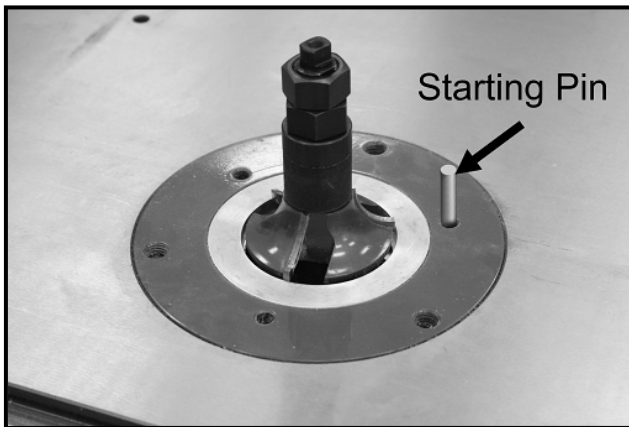

Figure-30 Starting pin

Use a hold down jig or push blocks for the safety of your hands and place the work-piece against the starting pin.

Plug the cord into the receptacle and turn the machine “ON”. Slowly pivot and feed the work-piece into the cutter and try to avoid starting your cut on the corner of the work-piece to avoid kick back.

USING COLLARS

When shaping work-pieces that have irregular shapes, it is necessary to use collars. Collars can be used below or above the cutter or between two cutters. Each setup type has its own advantages and disadvantages.

Below the Cutter

When using collar below that cutter, the user will have a good view of the cut. But if the work-piece is lifted even slightly, it will cause the cutter to gouge the wood and ruin the work-piece.

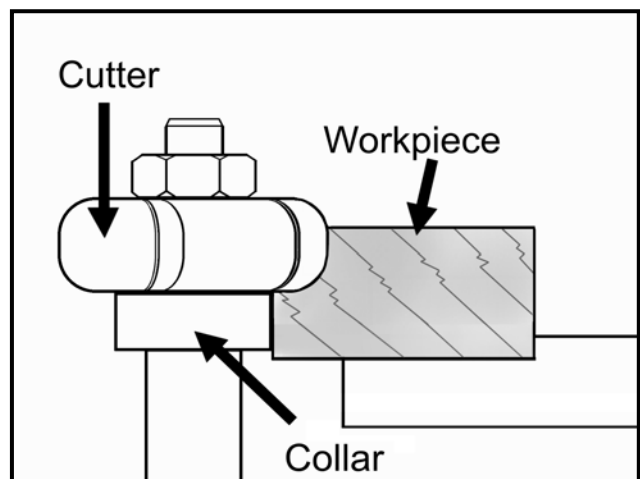

Figure-31 Using collars below the cutter

Above the Cutter

When using the collar above the cutter as shown in figure-32, the cut will not be affected by slight variations in the thickness of the work-piece and the work-piece will not be gouged if lifted up accidentally.

The only disadvantage of using a collar above the cutter is that the operator will not be able to see the cut being made.

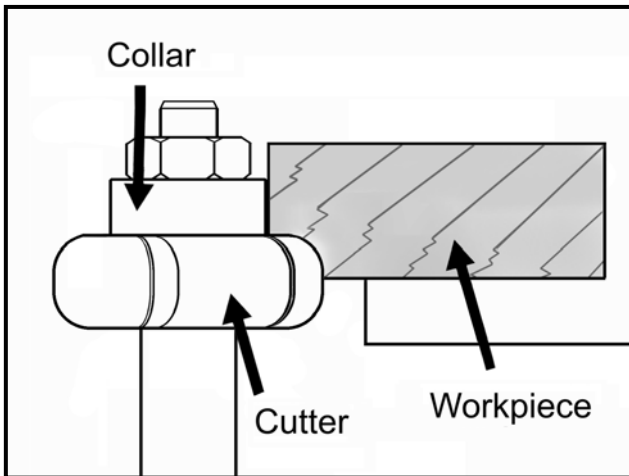

Figure-32 Using collar above the cutter

Between the Cutters

A collar is used between two cutters when both edges of the work-piece are to be shaped.

Like using the collar below the cutter, this method has also the disadvantage that if the work-piece is accidentally lifted up, the cutter will gouge and ruin the work-piece.

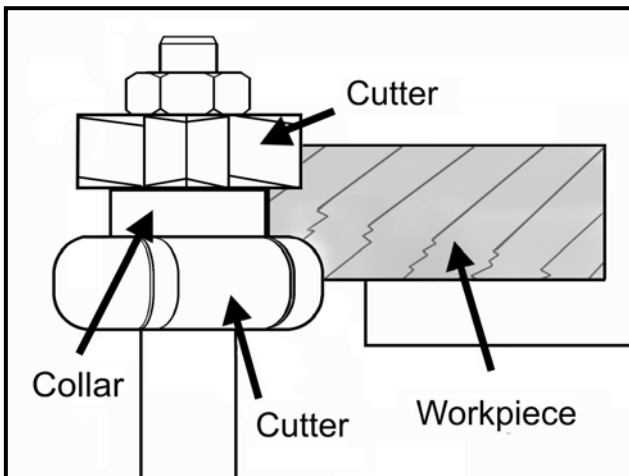

Figure-33 Using collar between the cutters

MAINTENANCE

During the life of your machine, you will need to practice some regular maintenance to keep your saw in peak performance condition.

WARNING

Make sure the machine is turned off and the cord is disconnected from the power source before servicing and removing/replacing any components on the machine.

LUBRICATION

The shaper has sealed lubricated bearings in the motor housing and arbour assembly and do not require any lubrication.

CLEANING

The moisture from the wood dust remaining on the table surface can cause rust. The table and other un-painted surfaces of the machine should be cleaned and wiped after every use to make sure that there is no moisture against bare metal surfaces.

V-BELT INSPECTION

The V-belt stretches with use and should be checked regularly. Check the V-belt for proper tension and belt condition every month.

TROUBLESHOOTING

PROBLEM	POSSIBLE CAUSE	SOLUTION
The shaper does not start	1. The supply circuit has low/no voltage or high resistance.	1. If you are unqualified to test voltage determine circuit loads, or rewire, contact a qualified electrician. / Check breaker
	2. The motor start capacitor is open or shorted.	2. Unplug the shaper and inspect the capacitor for oily residue, bubbled plastic, foul odor & test and replace accordingly.
	3. Forward/Reverse switch is in the "OFF" position.	3. Make sure the switch is in the "Forward" or "Reverse" position.
The shaper runs slow.	1. The belt-to-pulley ratio is set low speed.	1. Unplug the shaper and move the belt to the high speed pulley position.
	2. The extension cord used is the wrong gauge and has too much resistance, or supply circuit has low voltage, or high resistance.	2. Eliminate the extension cord and move the shaper closer to the wall receptacle. If you are unqualified to test or determine circuit loads, contact a qualified electrician.
The drive belt tears or runs off the shaper.	1. The belt tension is too low and the belt has run off the pulley.	1. Increase the belt tension to prevent slippage. DO NOT over tighten the belt tension.
The shaper vibrates, the spindle is loose or the cutter chatters.	1. The shaper is unstable and wobbles.	1. Stabilize the shaper with the floor, using shims.
	2. The spindle, cutter, or router bit spindle adapter is loose or out of alignment.	2. Reinstall spindle, cutter or router bit spindle adapter as outlined.
	3. The shaper has a loose motor or spindle cartridge.	3. Unplug the shaper & carefully look for loose motor, motor mounts, spindle cartridge or other parts. Tighten fasteners as required.
	4. The motor or spindle cartridge bearings are at fault.	4. Replace bearings or spindle cartridge assembly as required.

CX300 BODY PARTS BREAKDOWN

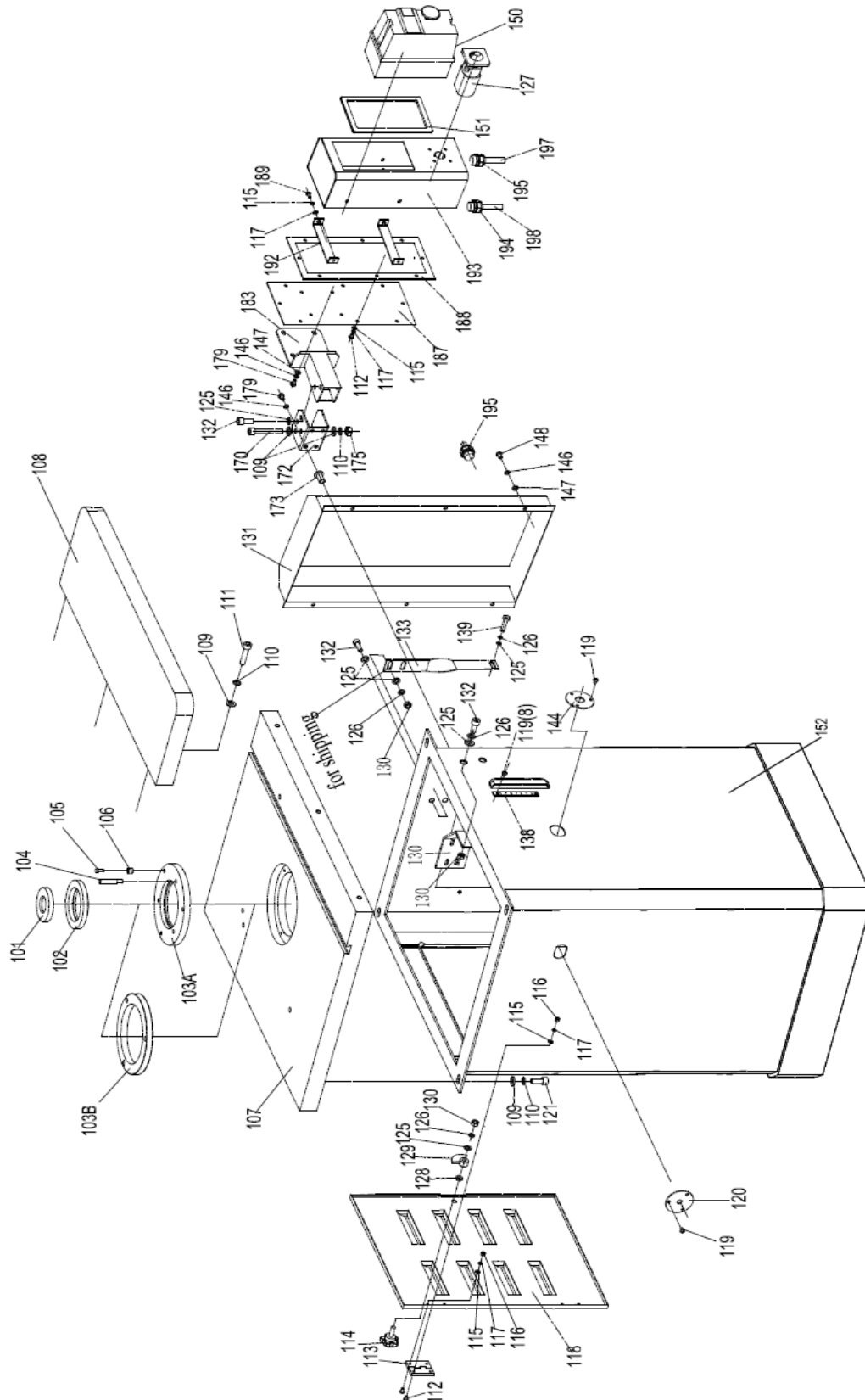

CX300 BODY PARTS LIST

REF#	DESCRIPTION	QTY
101	TABLE INSERT	1
102	TABLE INSERT	1
103A	TABLE INSERT	1
103B	TABLE INSERT	1
104	PIN	1
105	CAP SCREW M5X20	3
106	SET SCREW	3
107	MAIN TABLE	1
108	EXTENSION TABLE	1
109	FLAT WASHER 10MM	8
110	LOCK WASHER 10MM	7
111	CAP SCREW M10X35	3
112	CAP SCREW M5x12	16
113	HINGE	2
114	KNOB	1
115	FLAT WASHER 5MM	20
116	LOCK WASHER 5MM	20
117	NUT M5	8
118	BACK COVER	1
119	TAPPING SCREW ST4.8X16	8
120	LOCK COVER	1
121	CAP SCREW M10X25	4
125	FLAT WASHER 8MM	7
126	LOCK WASHER 8MM	6
127	FOR/REV SWITCH	1
128	THIN NUT M8	1
129	DOOR LOCK	1
130	NUT M8	6

REF#	DESCRIPTION	QTY
131	SIDE COVER	1
132	CAP SCREW M8X20	5
133	SHIPPING STRIP	1
134	SWITCH SUPPORT BRACKET	1
138	SCALE	1
139	HEX SCREW M8X20	1
144	COVER	1
146	LOCK WASHER 6MM	14
147	FLAT WASHER 6MM	10
148	CAP SCREW M6x12	6
150	MAGNETIC SWITCH	1
151	GASKET	1
152	CABINET STAND	1
170	CAP SCREW M10X65	1
172	BARACKET	1
173	RIVETED NUT M6	4
175	NUT M10	1
179	CAP SCREW M6x16	8
183	BRACKET	1
187	PLATE	1
188	GASKET	1
189	CAP SCREW M5x16	4
192	STRIP	2
193	SWITCH BOX	1
194	STRAIN RELIEF PG11	1
195	STRAIN RELIEF PG13.5	3
197	POWER CORD 14AWGX3C	1
198	POWER CORD 14AWGX3C	1

CX300 ELEVATION PARTS BREAKDOWN

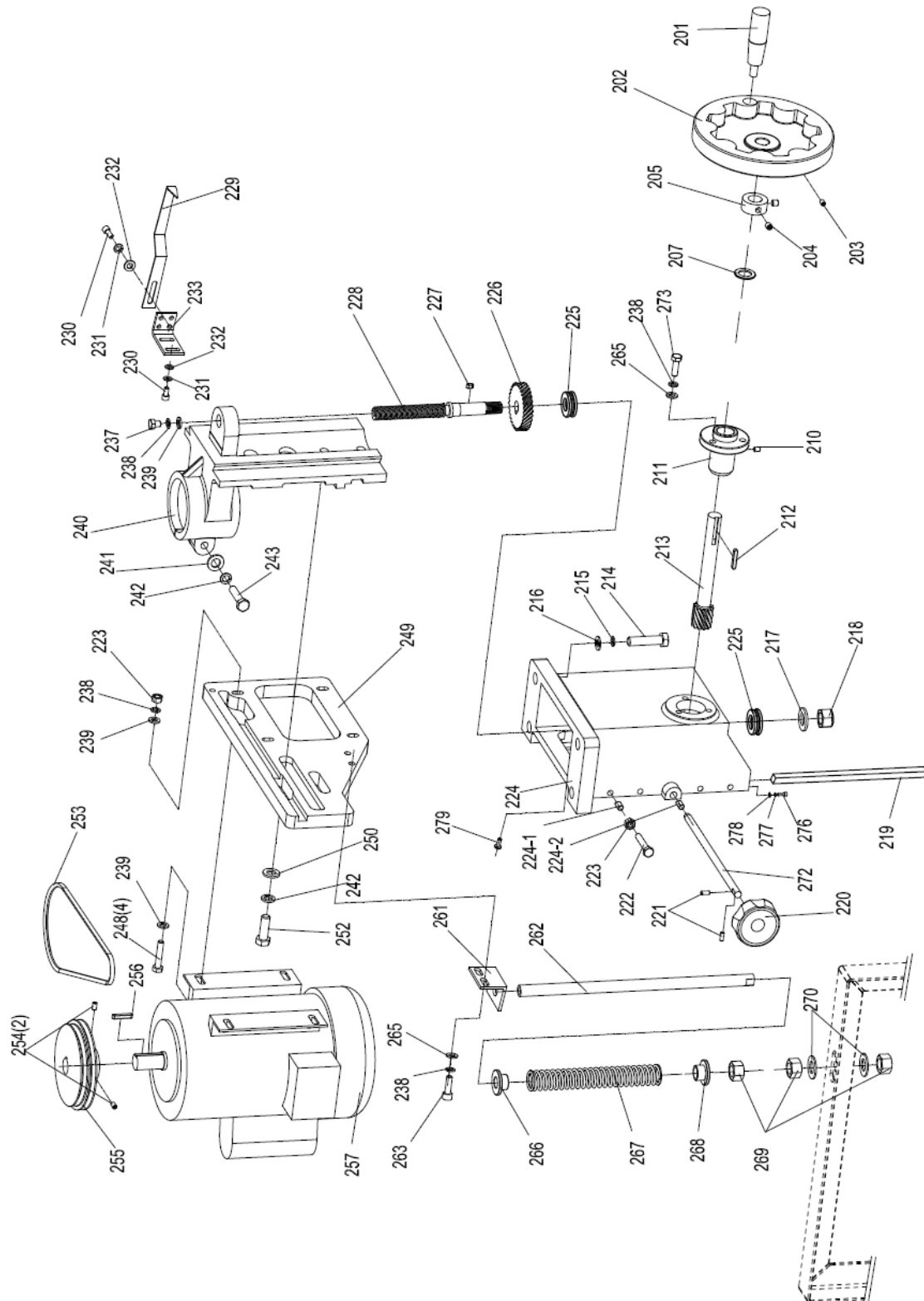

CX300 ELEVATION PARTS LIST

REF#	DESCRIPTION	QTY
201	HANDWHEEL HANDLE	1
202	HANDWHEEL	1
203	SET SCREW M5x10	1
204	SET SCREW M6x8	2
205	BUSHING	1
207	SPACER	1
210	SET SCREW M6x5	1
211	SHAFT MOUNT	1
212	KEY 5*5*30	1
213	WORM SHAFT	1
214	HEX BOLT M12*45	4
215	LOCK WASHER 12MM	4
216	FLAT WASHER 12MM	4
217	FLAT WASHER 16MM	1
218	LOCK NUT M16X1.5	1
219	GIB	1
220	LOCK KNOB	1
221	SET SCREW M5x6	2
222	HEX BOLT M8X30	4
223	NUT M8	8
224	ELEVATION HOUSING	1
224-1	GIB BLOCK 6.5	1
224-2	GIB BLOCK 8.5	4
225	BEARING 51203	2
226	GEAR	1
227	KEY 5*5*10	1
228	ELEVATION LEAD SCREW	1
229	POINTER	1
230	CAP SCREW M6X12	4
231	LOCK WASHER 6MM	4
232	FLAT WASHER 6MM	4
233	POINTER MOUNT	1

REF#	DESCRIPTION	QTY
237	HEX BOLT M8X15	1
238	LOCK WASHER 8MM	13
239	FLAT WASHER 8MM	9
240	SPINDLE SLIDE	1
241	FLAT WASHER 10MM	1
242	LOCK WASHER 10MM	3
243	HEX BOLT M10X45	1
248	HEX BOLT M8X40	4
249	MOTOR BRACKET	1
250	FLAT WASHER 10MM	2
252	HEX BOLT M10X40	2
253	BELT	1
254	SET SCREW M6x10	2
255	MOTOR PULLEY	1
256	KEY 4.76*4.76*32	1
257	MOTOR	1
261	SUPPORT WASHER	1
262	SUPPORT BOLT	1
263	CAP SCREW M8X20	2
265	FLAT WASHER 8MM	5
266	SUPPORT WASHER	1
267	SPRING	1
268	SUPPORT WASHER	1
269	NUT M16	3
270	FLAT WASHER 16MM	2
272	LOCK KNOB SHAFT	1
273	HEX BOLT M8X25	3
276	CAP SCREW M5*8	2
277	LOCK WASHER 5MM	2
278	FLAT WASHER 5MM	2
279	CAP SCREW M5*25	1

CX300 SPINDLE PARTS BREAKDOWN

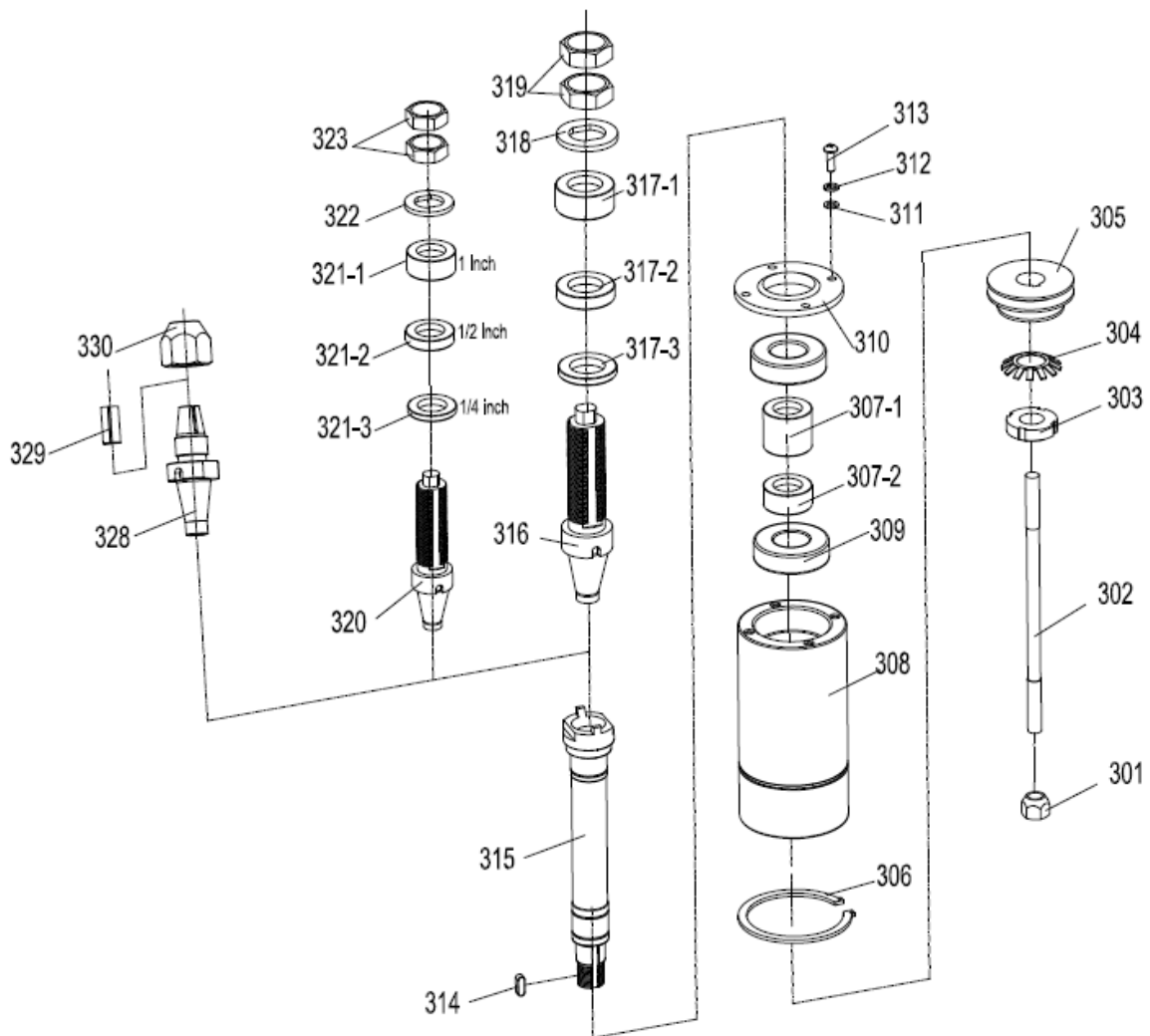

CX300 SPINDLE PARTS LIST

REF#	DESCRIPTION	QTY
301	DRAW NUT	1
302	DRAW BAR	1
303	NUT M20	1
304	TOOTHED WASHER	1
305	PULLEY	1
306	SNAP RING	1
307-1	LONG WASHER	1
307-2	SHORT WASHER	1
308	HOUSING	1
309	BEARING 6205-2Z	2
310	FLANGE	1
311	FLAT WASHER 5MM	4
312	LOCK WASHER 5MM	4
313	CAP SCREW M5*16	4
314	KEY 5*5*30	1
315	1"ARBOR	1

REF#	DESCRIPTION	QTY
316	3/*4" SPINDLE	1
317-1	1" SPINDLE WASHER 1"	1
317-2	1" SPINDLE WASHER 1/2"	1
317-3	1" SPINDLE WASHER 1/4"	1
318	1" SPINDLE LOCK WASHER	1
319	1" NJUT	2
320	3/*4" SPINDLE	1
321-1	3/*4" SPINDLE WASHER 1"	1
321-2	3/*4" SPINDLE WASHER 1/2"	1
321-3	3/*4" SPINDLE WASHER 1/4"	1
322	3/*4" SPINDLE LOCK WASHER	1
323	3/*4" NJUT	2
328	ROUTER BIT BODY	1
329	ROUTER BIT BUSHING	1
330	ROUTER BIT CAP	1

CX300 MITER GAUGE PARTS BREAKDOWN

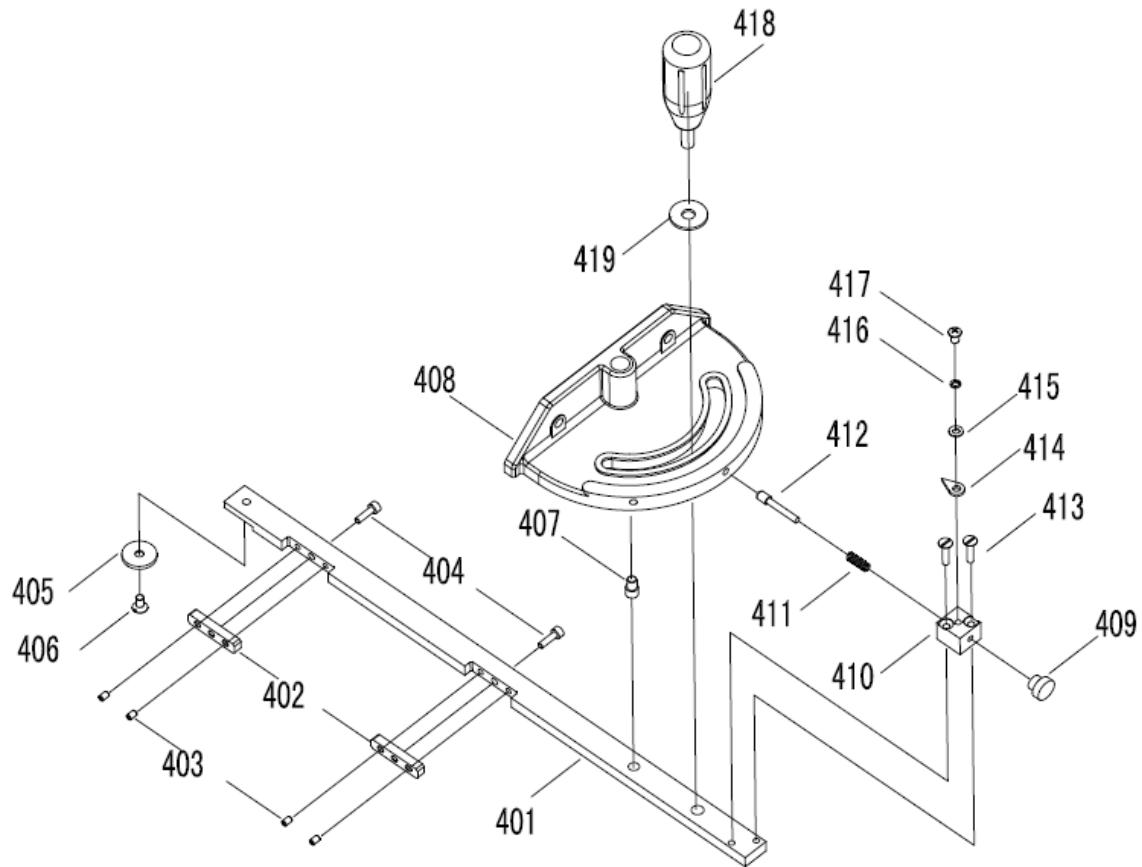

CX300 MITER GAUGE PARTS LIST

REF#	DESCRIPTION	QTY
401	MITER BAR	1
402	GIB	2
403	SET SCREW M4-.7*6	4
404	CAP SCREW M4-.7*14	2
405	MITER RING	1
406	FLAT HD SCR M5-.8*8	1
407	MITER BODY PIVOT PIN	1
408	MITER GUAGE BODY	1
409	MITER STOP PIN KNOB	1

REF#	DESCRIPTION	QTY
410	MITER STOP PIN BLOCK	1
411	COMPRESSION SPRING	1
412	MITER STOP PIN	1
413	CAP SCREW M4-.7*14	2
414	POINTER MITER GUAGE	1
415	FLAT WASHER 4MM	1
416	LOCK WASHER 4MM	1
417	PHLP HD SCR M4-.7*8	1
418	MITER KNOB	1
419	FENDER WASHER 10MM	1

CX300 FENCE PARTS BREAKDOWN

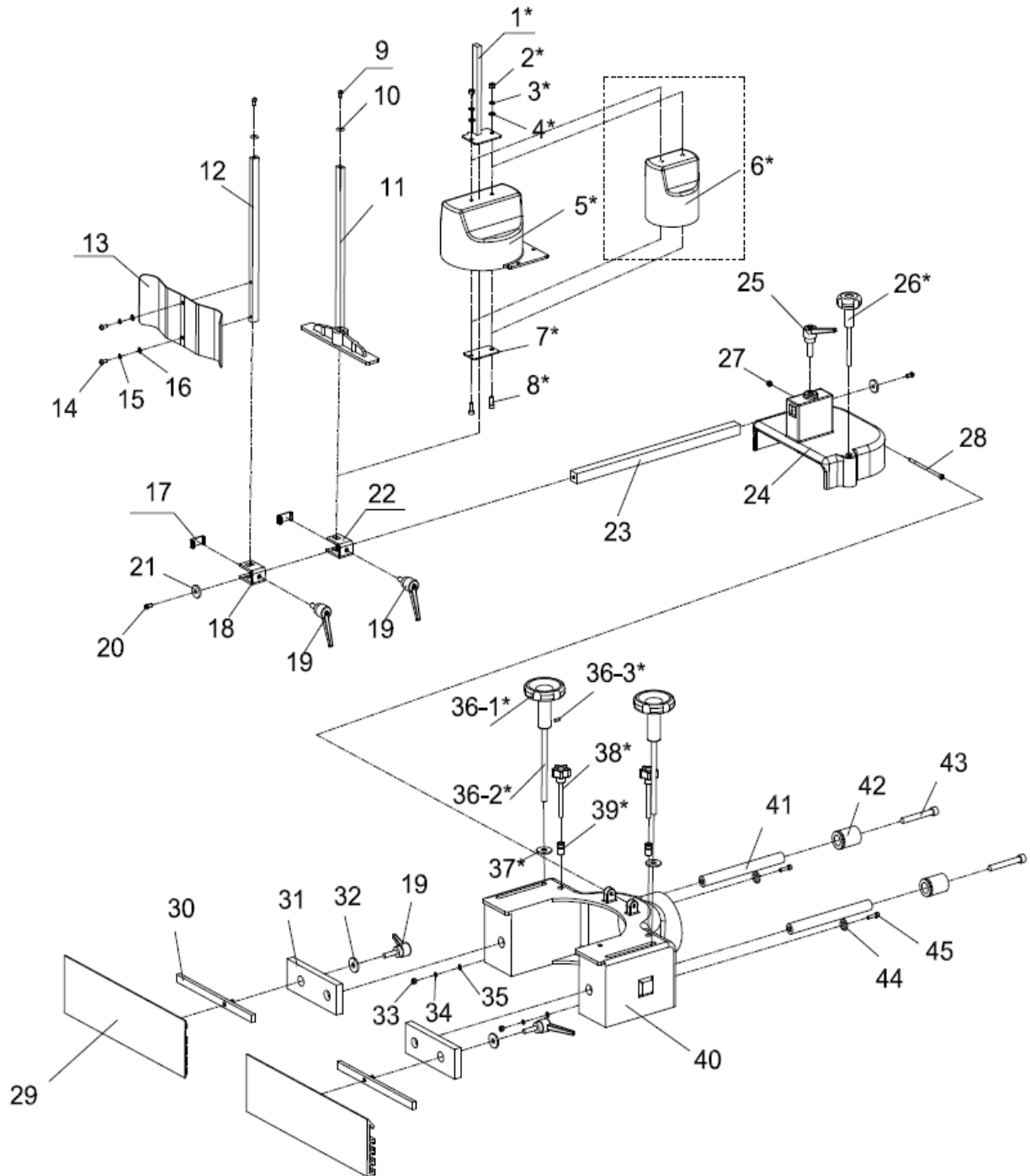

CX300 FENCE PARTS LIST

REF#	DESCRIPTION	QTY
1	BAR	1
2	NUT M6	2
3	ELASTIC WASHER	2
4	FLAT WASHER	2
5	6"GUARD	1
6	3.5"GUARD	1
7	BAR WASHER	1
8	CAP SCREW M6x16	2
9	PAN SCREW M5x10	2
10	FLAT WASHER	2
11	BAR	1
12	BAR	1
13	GUIDE	1
14	CAP SCREW	2
15	PAN HEAD SCREW	2
16	ELASTIC WASHER	2
17	STRIP	3
18	LOCK BRACKET	1
19	LOCK LEVER	4
20	PAN SCREW M6x12	2
21	FLAT WASHER	2
22	LOCK BRACKET	1
23	BAR	1
24	PLATE	1

REF#	DESCRIPTION	QTY
25	LOCK LEVER	1
26	KNOB	1
27	LOCK NUT M5	1
28	CAP SCREW M5*100	1
29	FENCE	2
30	LOCK BLOCK	2
31	FENCE BLOCK	2
32	FLAT WASHER	2
33	NUT M5	2
34	ELASTIC WASHER	2
35	FLAT WASHER	2
36-1	STAR KNOB M10*115	2
36-2	SET SCREW M5*8	2
36-3	KNOB SCREW M10*175	2
37	FLAT WASHER	2
38	LOCK KNOB	2
39	RIVET NUT M8*19.5	2
40	HOOD	1
41	GUIDE	2
42	ADJUST KNOB	2
43	CAP SCREW M10*70	2
44	LIMIT BLOCK	2
45	CAP SCREW M5*20	2



WARRANTY

CRAFTEX 3 YEARS LIMITED WARRANTY

Craftex warrants every product to be free from defects in materials and agrees to correct such defects where applicable. This warranty covers **three years** for parts and 90 days for labour (unless specified otherwise), to the original purchaser from the date of purchase but does not apply to malfunctions arising directly or indirectly from misuse, abuse, improper installation or assembly, negligence, accidents, repairs or alterations or lack of maintenance.

Proof of purchase is necessary.

All warranty claims are subject to inspection of such products or part thereof and Craftex reserves the right to inspect any returned item before a refund or replacement may be issued.

This warranty shall not apply to consumable products such as blades, bits, belts, cutters, chisels, punches etceteras.

Craftex shall in no event be liable for injuries, accidental or otherwise, death to persons or damage to property or for incidental contingent, special or consequential damages arising from the use of our products.

RETURNS, REPAIRS AND REPLACEMENTS

To return, repair, or replace a Craftex product, you must visit the appropriate Busy Bee Tools showroom or call 1-800-461-BUSY. Craftex is a brand of equipment that is exclusive to Busy Bee Tools.

For replacement parts directly from Busy Bee Tools, for this machine, please call 1-800-461-BUSY (2879), and have your credit card and part number handy.

- All returned merchandise will be subject to a minimum charge of 15% for re-stocking and handling with the following qualifications.
- Returns must be pre-authorized by us in writing.
- We do not accept *collect* shipments.
- Items returned for warranty purposes must be insured and shipped pre-paid to the nearest warehouse
- Returns must be accompanied with a copy of your original invoice as proof of purchase. Returns must be in an un-used condition and shipped in their original packaging a letter explaining your reason for the return. Incurred shipping and handling charges are not refundable.
- Busy Bee will repair or replace the item at our discretion and subject to our inspection.
- Repaired or replaced items will be returned to you pre-paid by our choice of carriers.
- Busy Bee reserves the right to refuse reimbursement or repairs or replacement if a third party without our prior authorization has carried out repairs to the item.
- Repairs made by Busy Bee are warranted for 30 days on parts and labour.
- Any unforeseen repair charges will be reported to you for acceptance prior to making the repairs.
- The Busy Bee Parts & Service Departments are fully equipped to do repairs on all products purchased from us with the exception of some products that require the return to their authorized repair depots. A Busy Bee representative will provide you with the necessary information to have this done.
- For faster service it is advisable to contact the nearest Busy Bee location for parts availability prior to bringing your product in for repairs.